

**PLATE SCHEDULE**

- F-1 PORTALS
- F-2 PLATFORMS
- F-3 CS DECKING AND COVERING
- F-4 CS FLATS
- F-5 USL FLATS
- F-6 SL FLATS
- F-7 ELX PRATICALS
- C-1 LAUAN CUTS

**NOTES FOR ALL PLATES AND CONSTRUCTION:**

1. UNLESS OTHERWISE SPECIFIED, GLUE MUST BE USED ON ALL JOINTS AND CONNECTIONS
2. UNLESS OTHERWISE SPECIFIED, CARPENTER MAY CHOOSE FASTENER TYPES.
3. STEP FACINGS SHALL BE INSTALLED AFTER CARRIAGE AND PLATS ARE IN PLACE.

**NOTES FOR ALL PLATFORM CONSTRUCTION:**

1. GLUE MUST BE USED ON ALL JOINTS AND CONNECTIONS IN PLATFORM CONSTRUCTION
2. UNLESS OTHERWISE SPECIFIED, CARPENTER MAY CHOOSE FASTENER TYPES.
3. BANDING SHOULD BE AT LEAST 1-1/2" WIDTH MINIMUM, SPACE 2" FROM FLOOR.
4. ALL LEGS OF 2'-6" HEIGHT (50") MUST BE BOLTED USING A MINIMUM OF 3/8" BOLTS.
5. WHEN PLATFORMS ARE JOINED AND LEGS ARE BOLTED, USE OF FLATHEAD BOLTS ARE REQUIRED.
6. ALL BOLTS CONNECTING PLATFORMS SHALL BE AT LEAST 3/8", GRADE 2 BOLTS, WITH WASHERS ON EACH SIDE OF CONNECTION.
7. ALL FACINGS MUST BE ATTACHED WITH A MINIMUM OF 1 1/4" #2 DRYWALL SCREWS SPACED ON 8" CENTERS. DO NOT GLUE FACINGS. DO NOT USE STAPLES TO ATTACH FACINGS.
8. ALL JOINTS IN FACINGS MUST BE FILLED VIA BONDO OR OTHER TD APPROVED FILLER.
9. ALL JOINTS ON FACINGS MUST BE MITERED.
10. ALL ACTING ESCAPE LEVELS ABOVE 1'-6" (18") MUST HAVE GARD RAILS AS DETAILED ON LEVELS AS DETAILED ON PLATE P2 AND P3
11. ALL ONSTAGE PLATFORM LEVELS MUST HAVE A TOE STRIP (3/4" X 5/4") INSTALLED ON THE EDGES.
12. SEE P3 FOR DETAILS ON CARRIAGE ATTACHMENTS
13. ALL PLATFORM SURFACES MUST HAVE HOLES FILLED AND NO FASTENERS PROTRUDING ABOVE LEVEL
14. CUT ALL LIDS AND THEN FRAME MATERIALS TO LID. (EXCLUDES ANY STEEL WORK)

**NOTES FOR ALL FLAT CONSTRUCTION:**

1. GLUE MUST BE USED ON ALL CONNECTIONS IN FLATS, REGARDLESS OF ORIENTATION.
2. ALL FLATS MUST BE ASSEMBLED USING STAPLES. USE OF SCREWS IS NOT ALLOWED.
3. ORIENTATION OF GRAIN ON ALL CORNERBLOCKS AND KEYSONES IS ESSENTIAL.
4. HARD COVER ALL FLATS. NOTE BENE MATCH LINES FOR LAUAN
5. ANY DOUBLE SIDED FLAT SHOULD BE CORREGUATED FASTENED AT ALL FRAME POINTS
6. DOOR OPENINGS RECEIVE STANDARD 1-1/2" SLAM STRIP. HARDWARE NEEDS TO BE PRATICAL.
7. SEE DESIGNER DRAWINGS FOR DETAILS ON DOOR OPENINGS WITHOUT DOORS
8. ALL SEAMS ON WALLS MUST BE BONDO FILLED, OR FILLED WITH A TD APPROVED ALTERNATE
9. UNLESS OTHERWISE INDICATED, ALL ELEVATIONS ARE FRONT ELEVATIONS OF THE FLATS

These drawings are instruments of service and as such remain the property of the creator. No copies or reproductions are permitted without the consent of the creator. Copyright (C) 2019

**FLORIDA ATLANTIC UNIVERSITY**

777 GLADES ROAD  
BOCA RATON, FL 33431  
PHONE: (561)297-3810, TD: (561)715-9898  
FAX: (561)297-0611

MARK	DATE	REVISIONS/ISSUES
1		
2		
3		
4		
5		
6		
7		

**URINETOWN**

THEATRE: STUDIO ONE THEATRE @ FAU  
DESIGNER: C GRIFFEY  
DIRECTOR: J. BALDET  
ISSUE DATE: 10/5/19  
AY FALL 2019

PLATE NUMBER  
**CVR**

SCALE:  
**1/2" = 1'-0"**

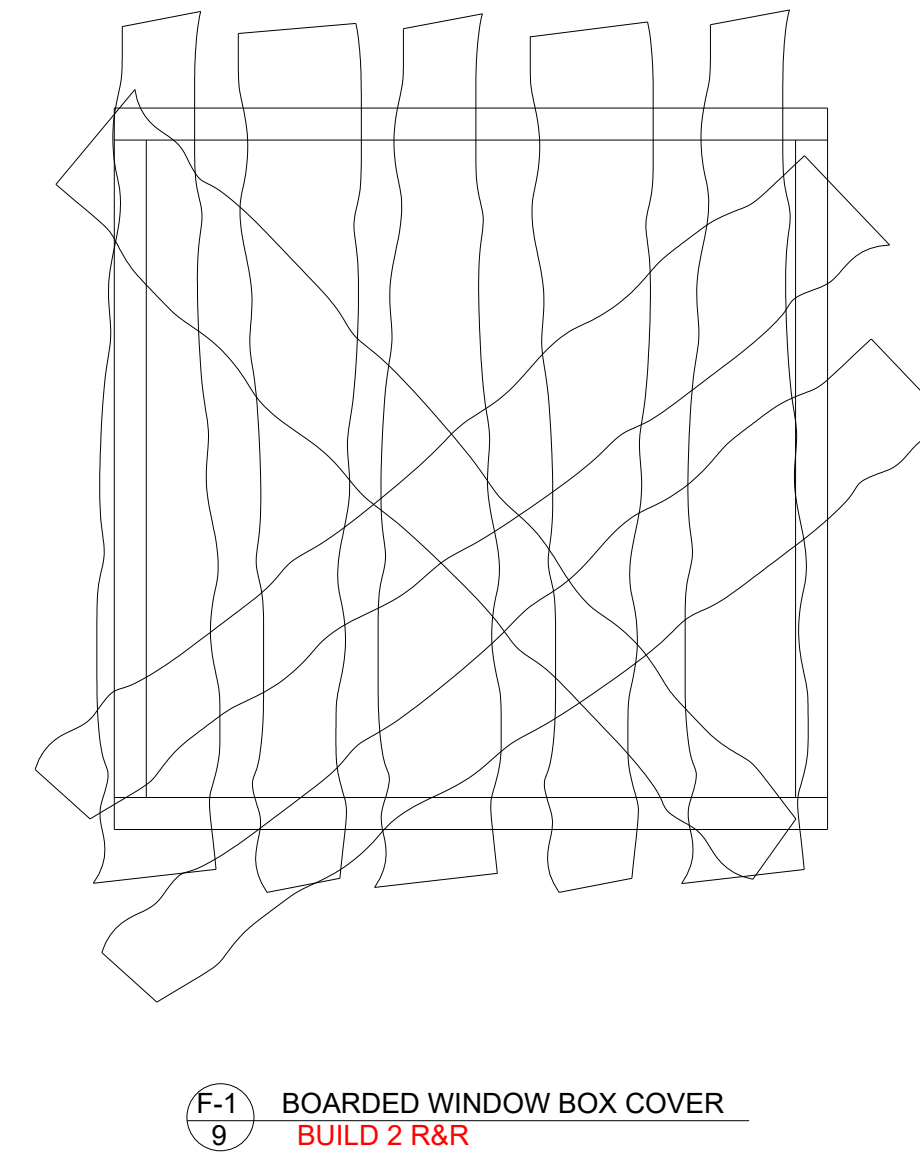
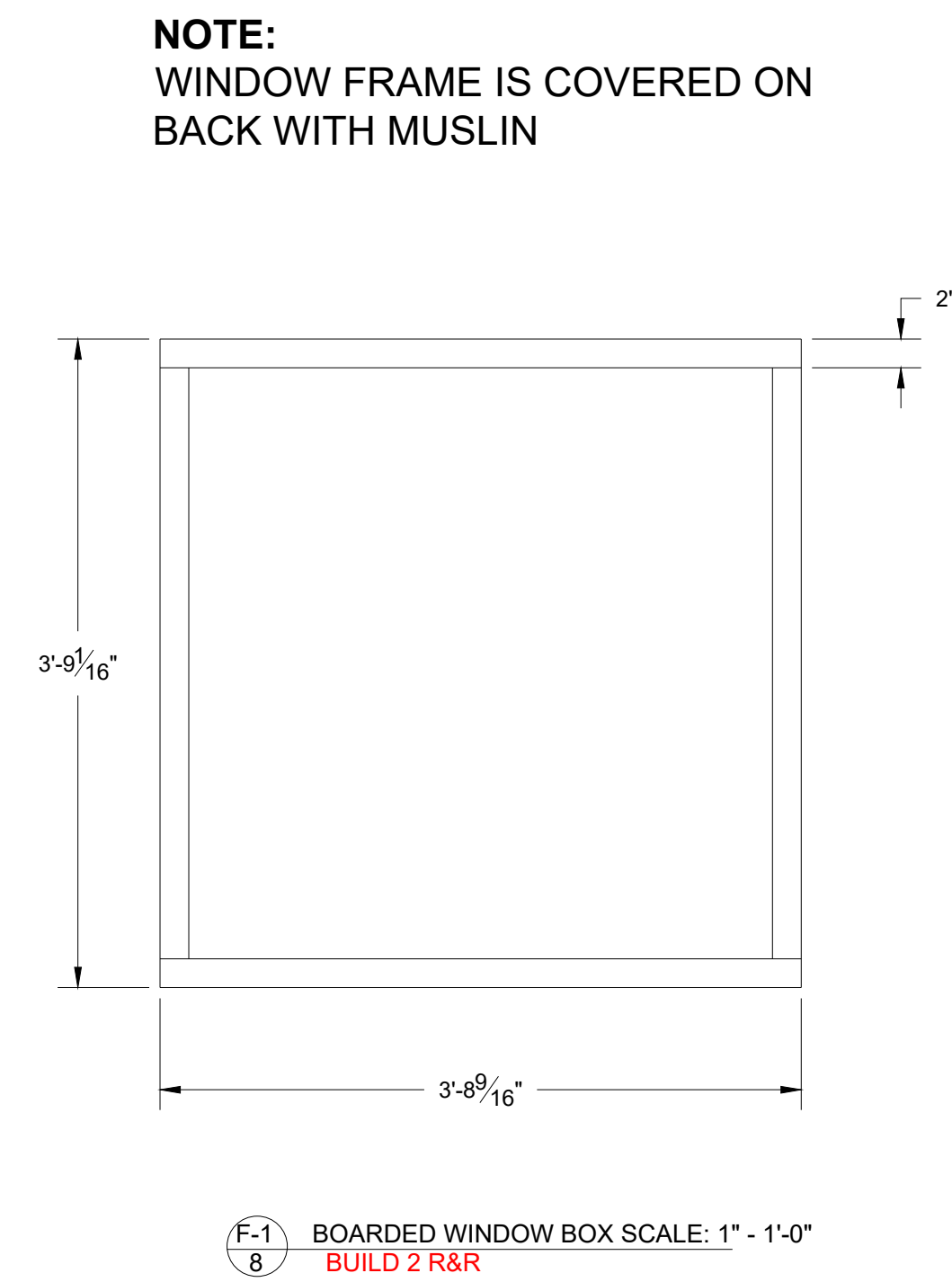
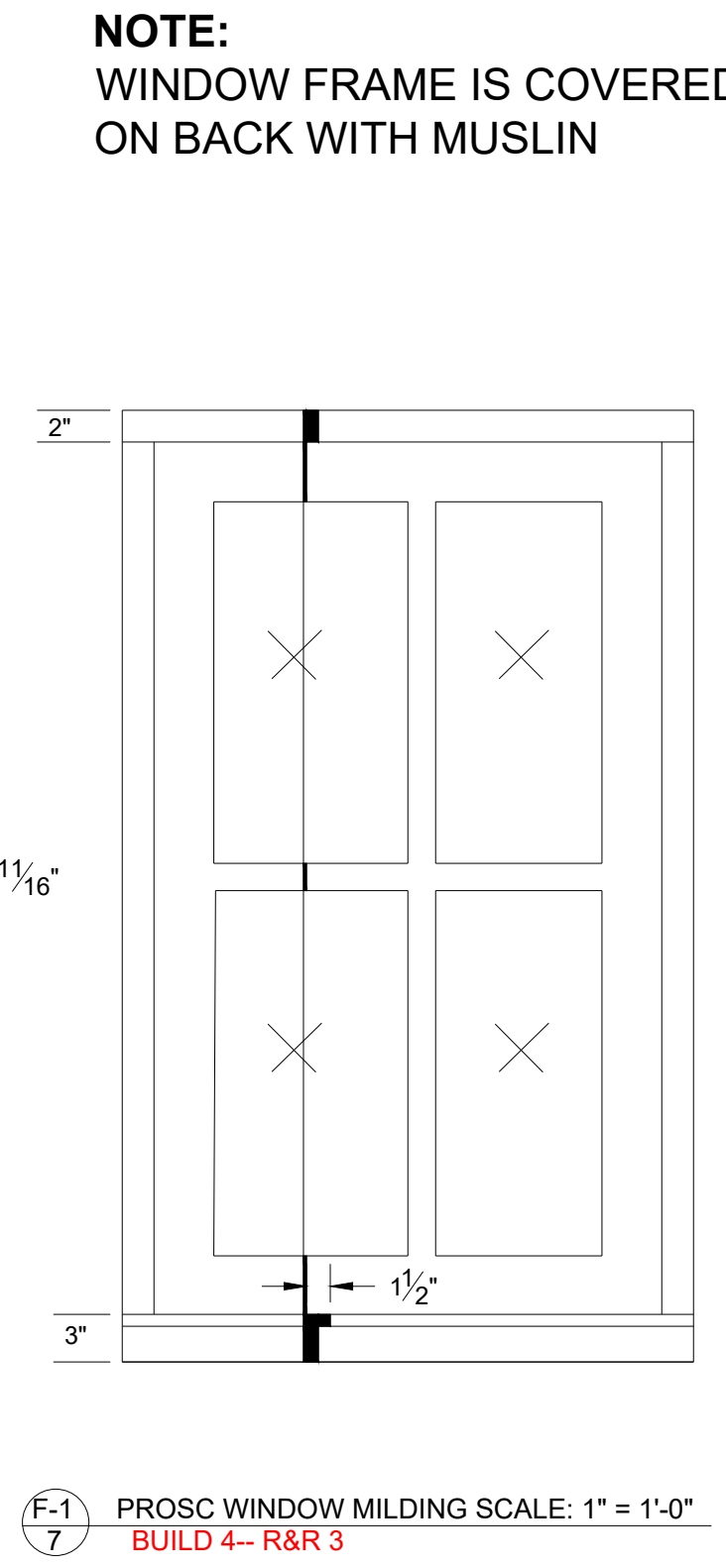
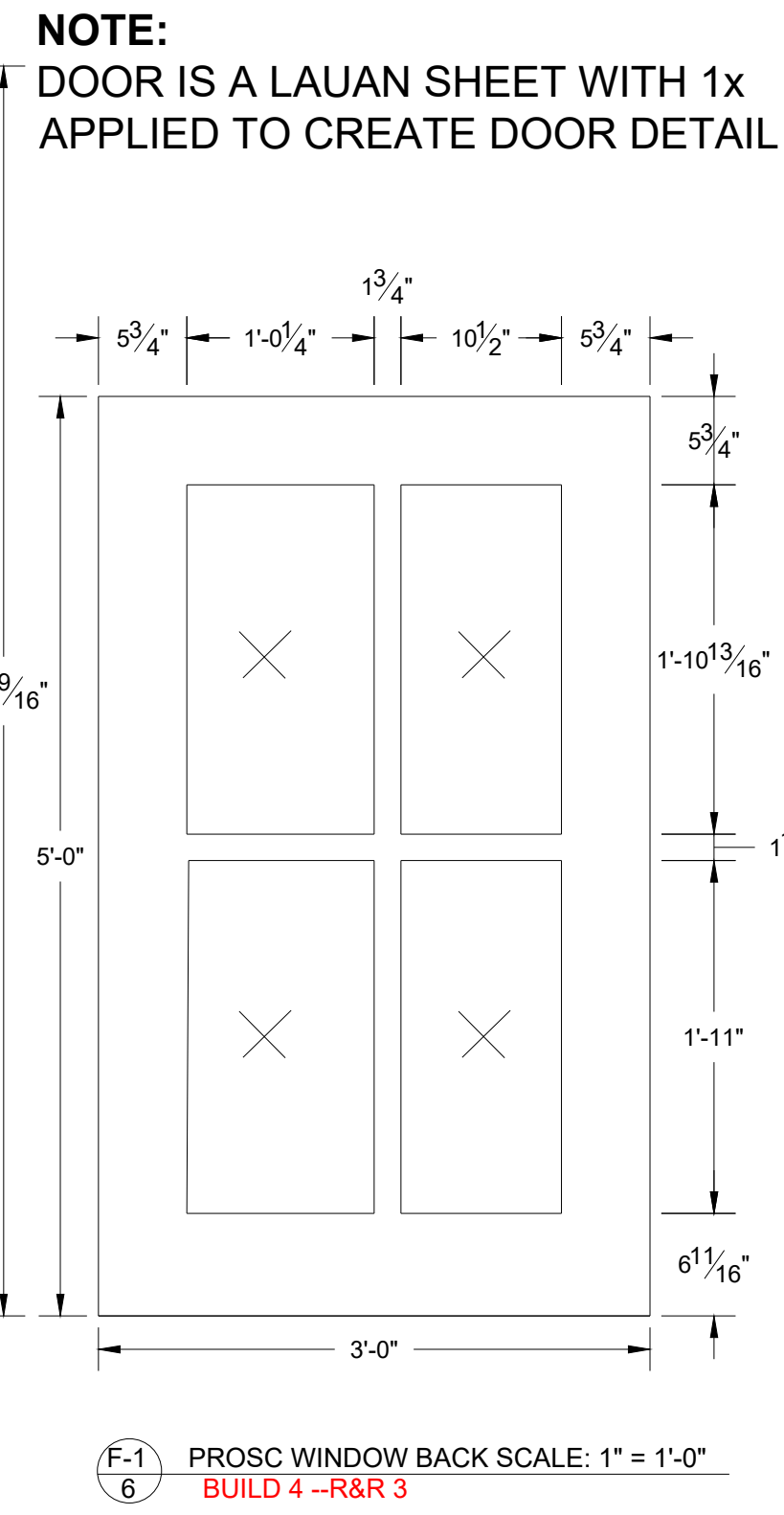
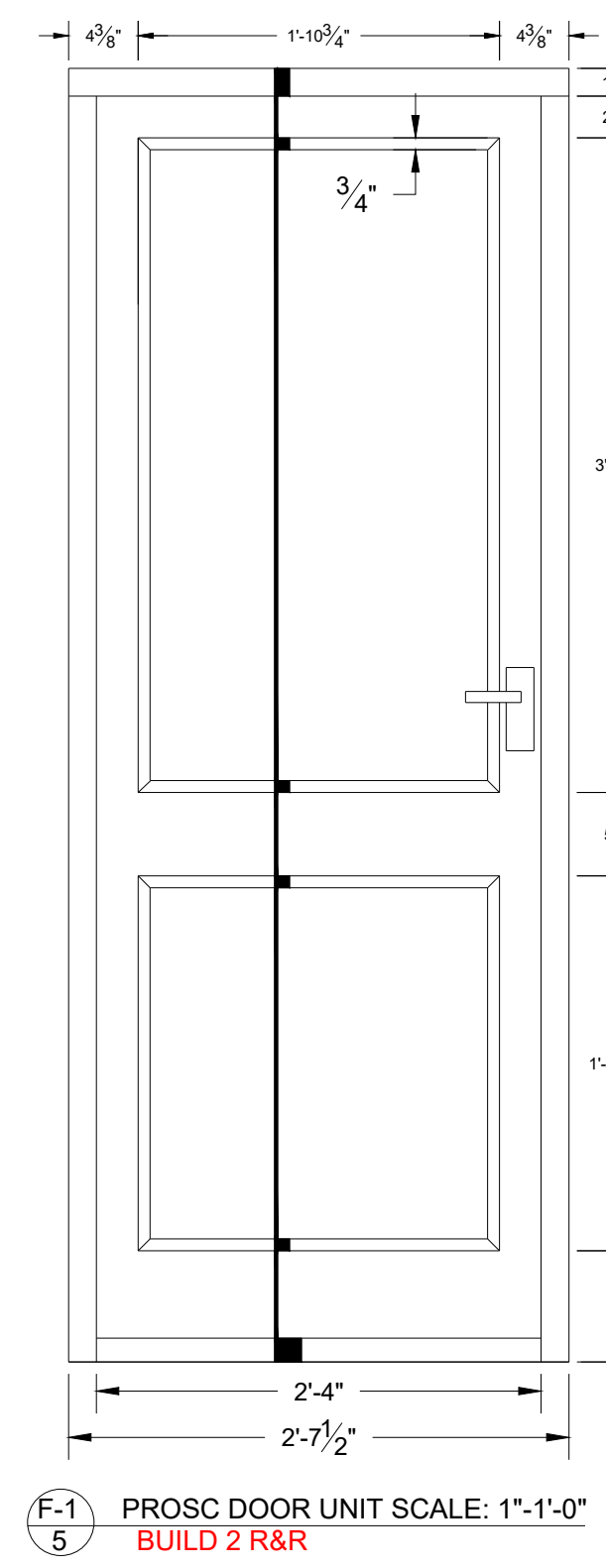
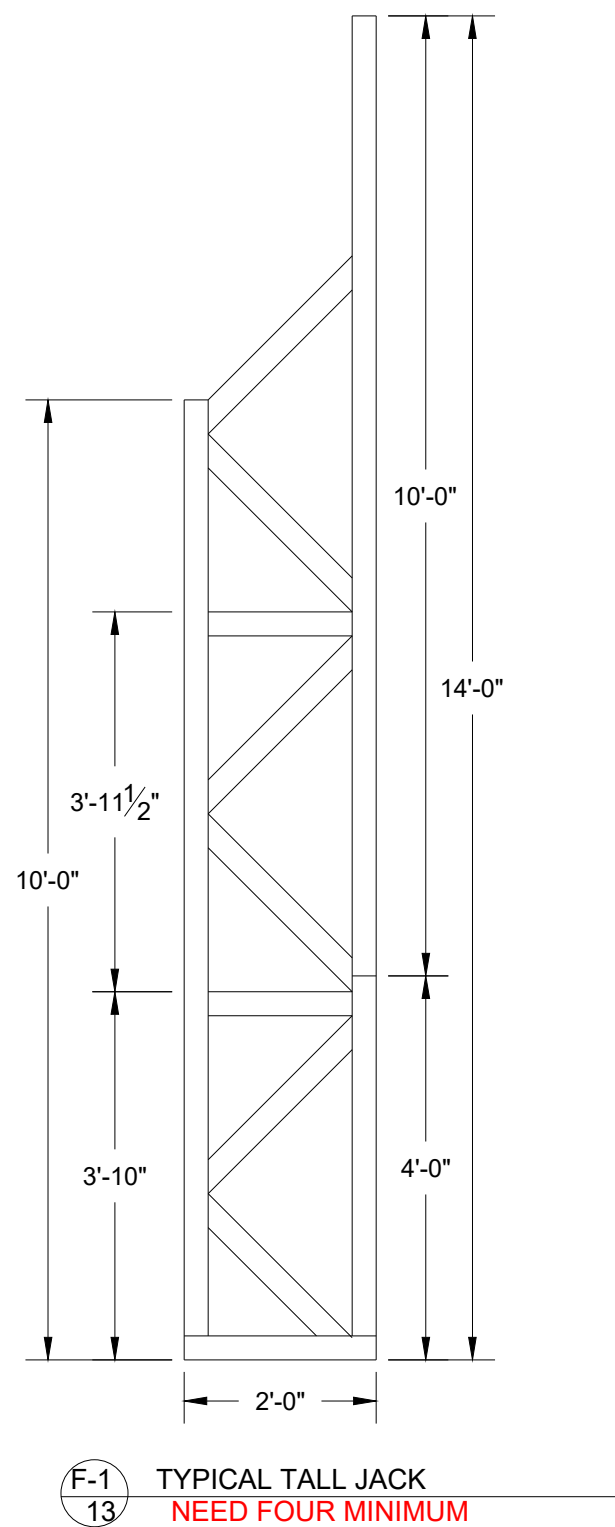
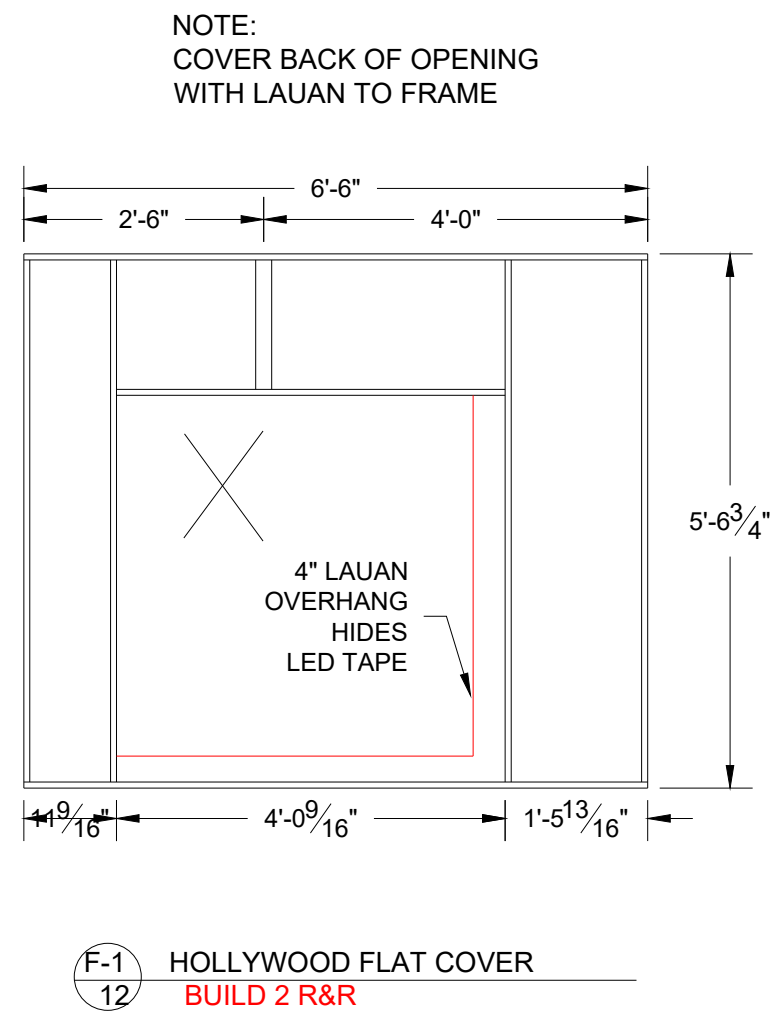
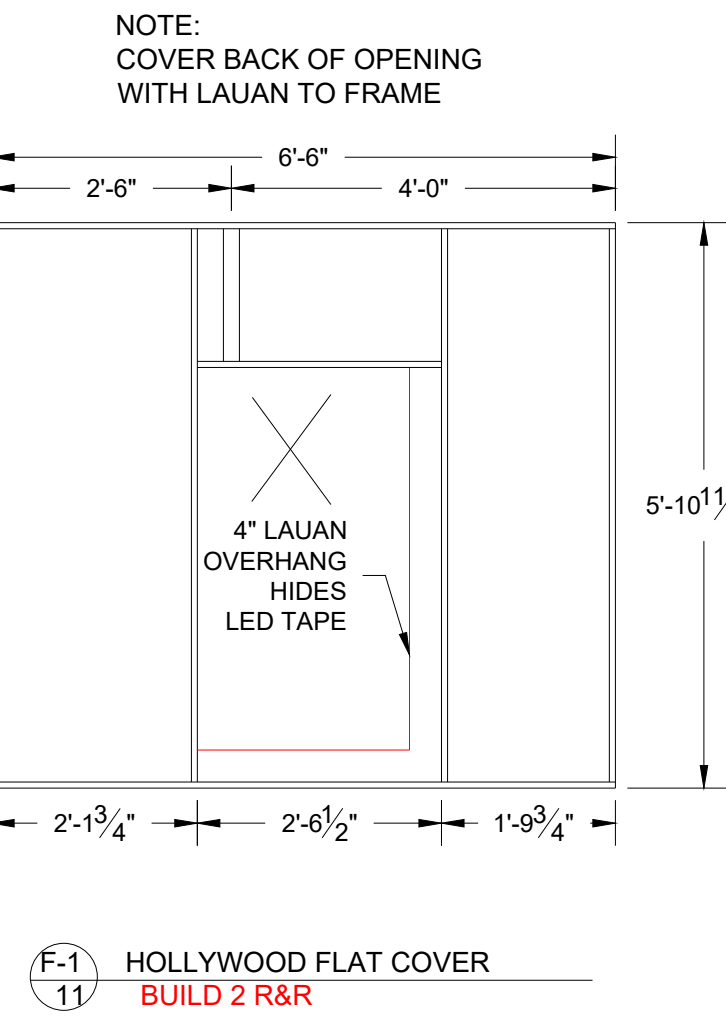
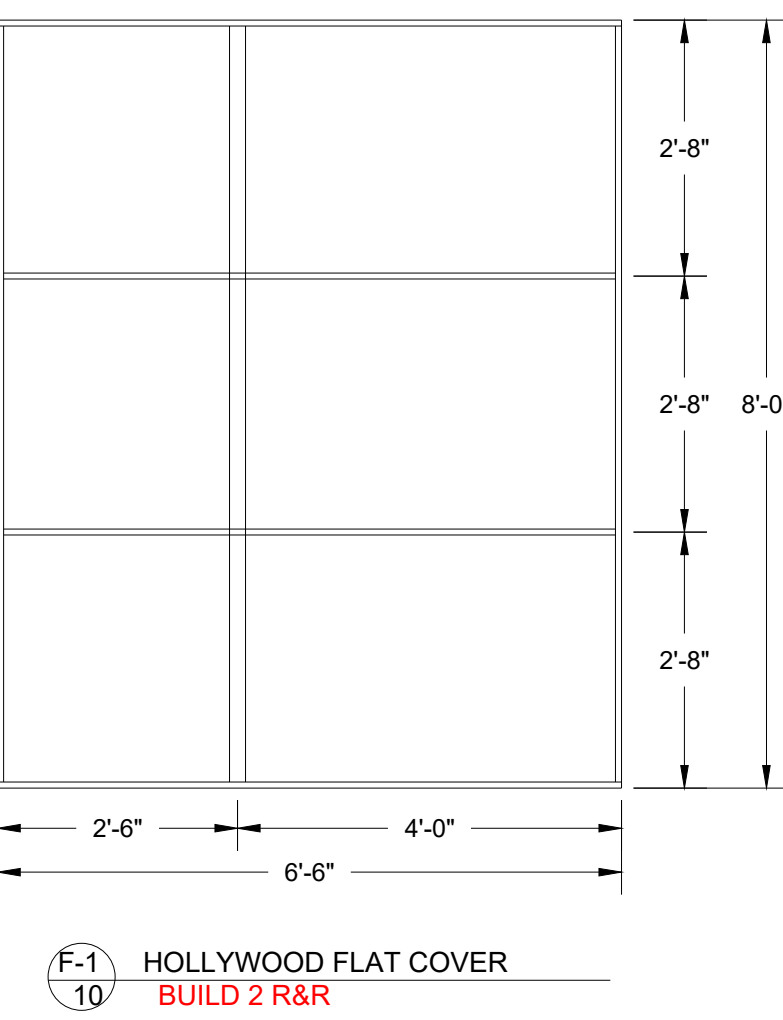
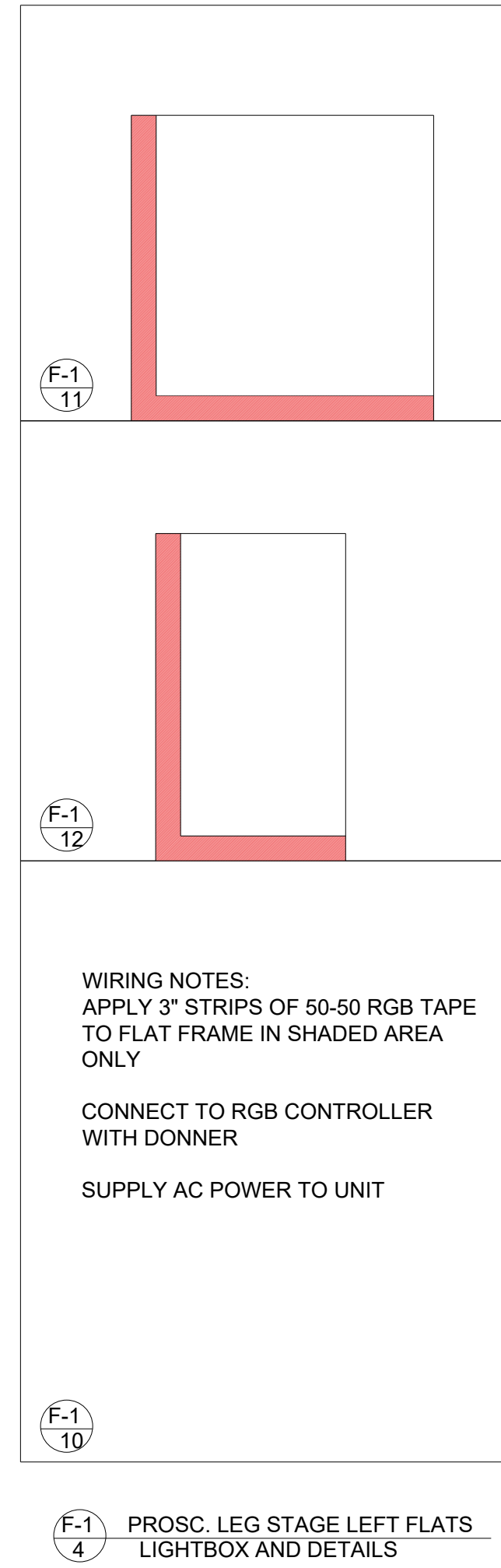
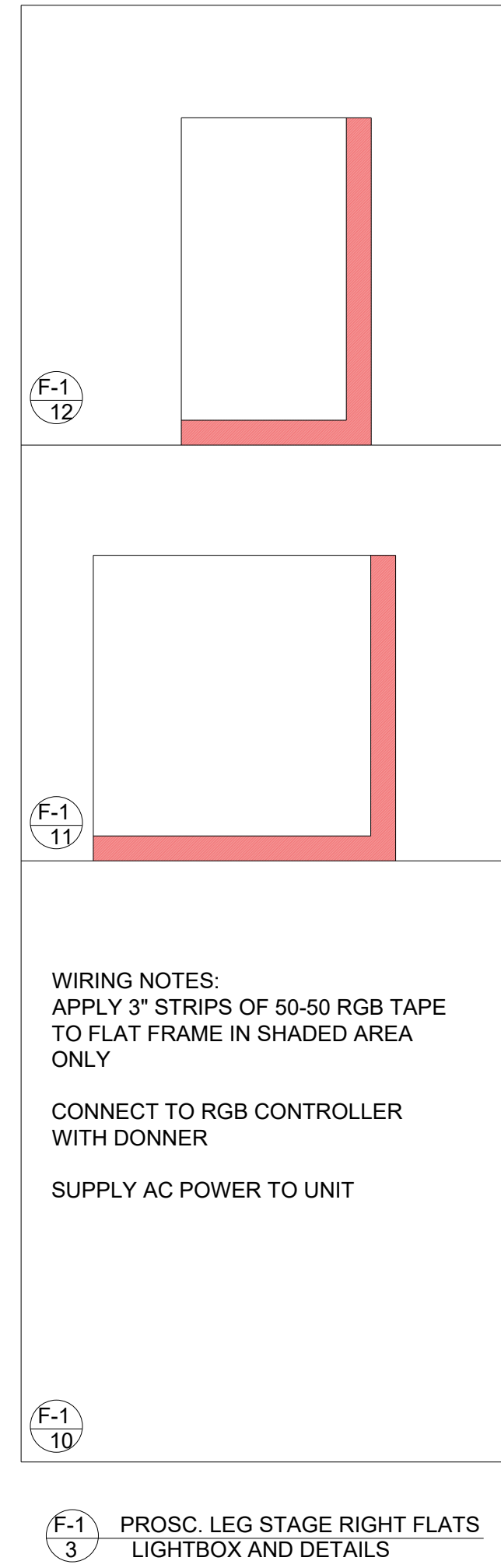
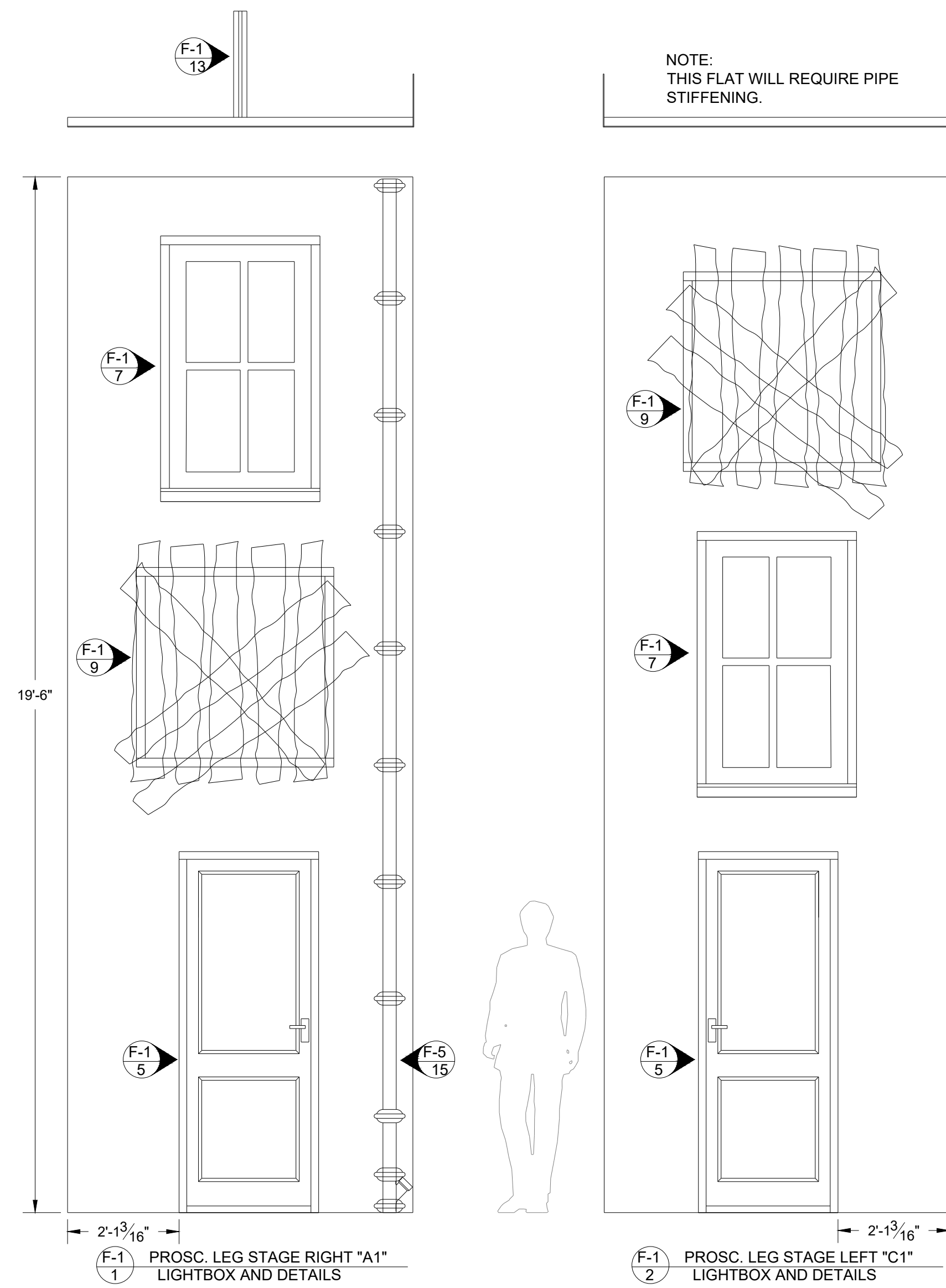

These drawings are instruments of service and as such remain the property of the creator. No copies or reproductions are permitted without the consent of the creator. Copyright (C) 2019

**FLORIDA ATLANTIC UNIVERSITY**  
777 GLADES ROAD  
BOCA RATON, FL 33431  
PHONE: (561)297-3810, TD: (561)715-9898  
FAX: (561)297-0611

MARK	DATE	REVISIONS/ISSUES
1		
2		
3		
4		
5		
6		
7		

**URINETOWN**  
THEATRE: STUDIO ONE THEATRE @ FAU  
DESIGNER: C. GRIFFEY  
DIRECTOR: J. BALDET  
ISSUE DATE: 10/5/19  
AY FALL 2019

PLATE NUMBER  
**F-1**

SCALE: 1/2" = 1'-0"

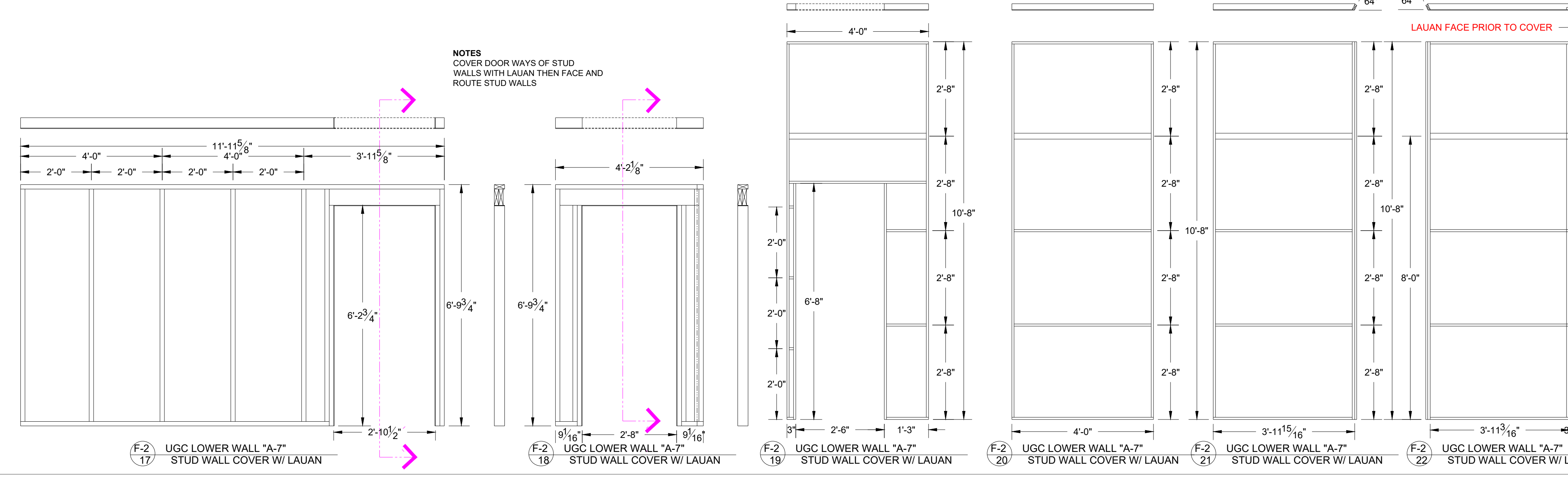
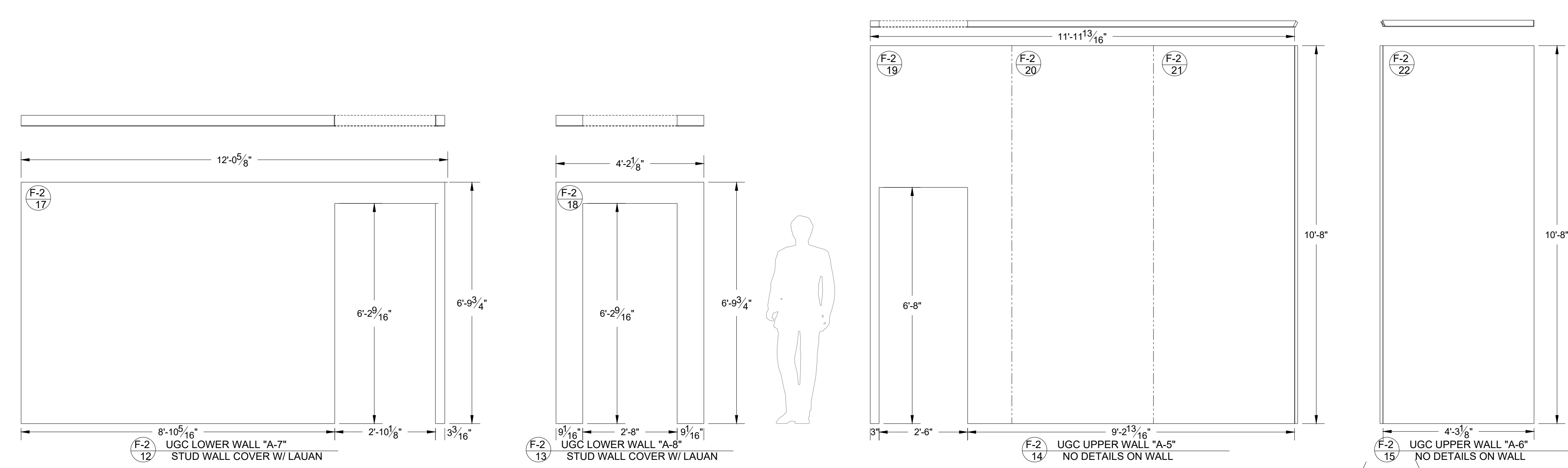
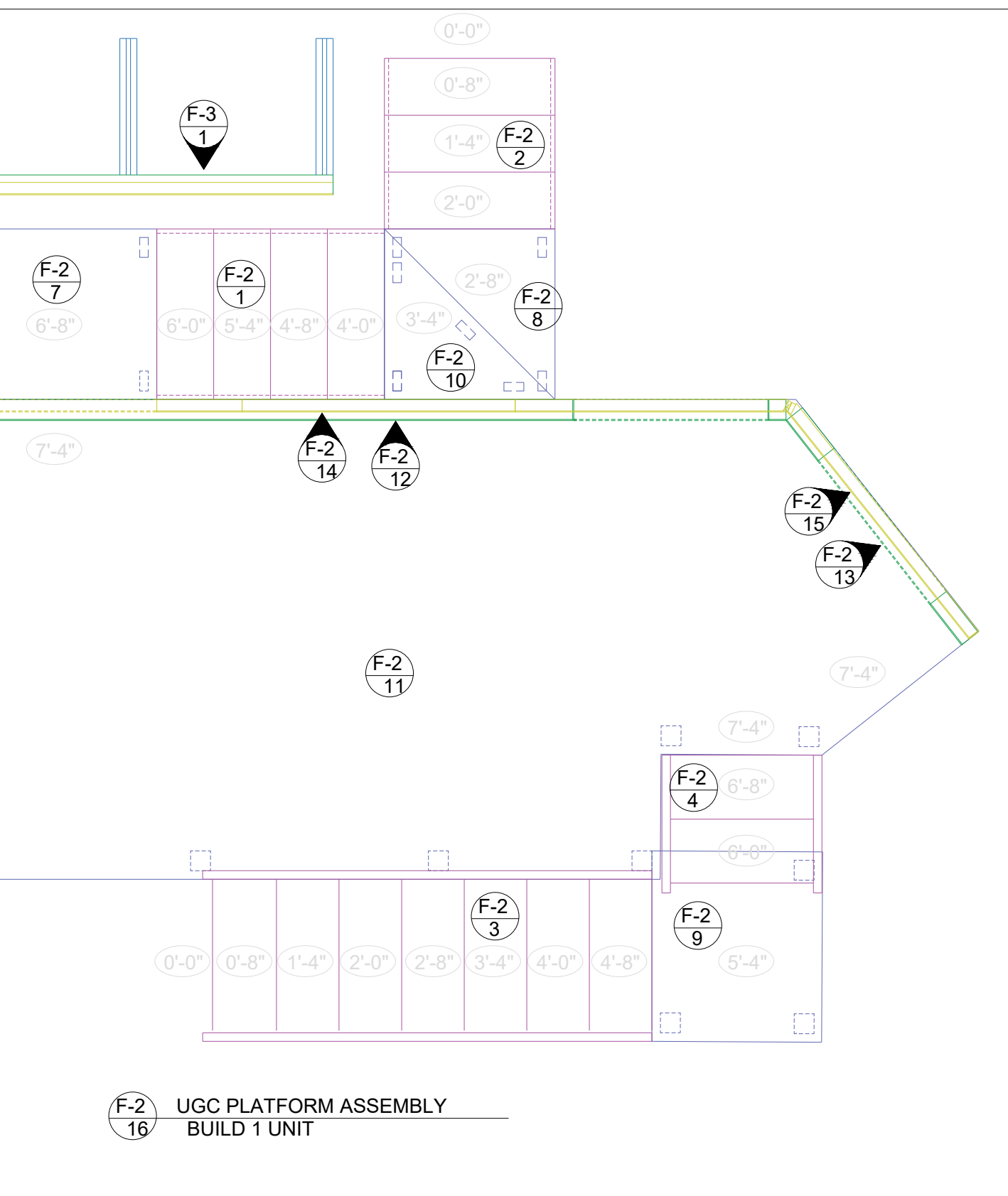
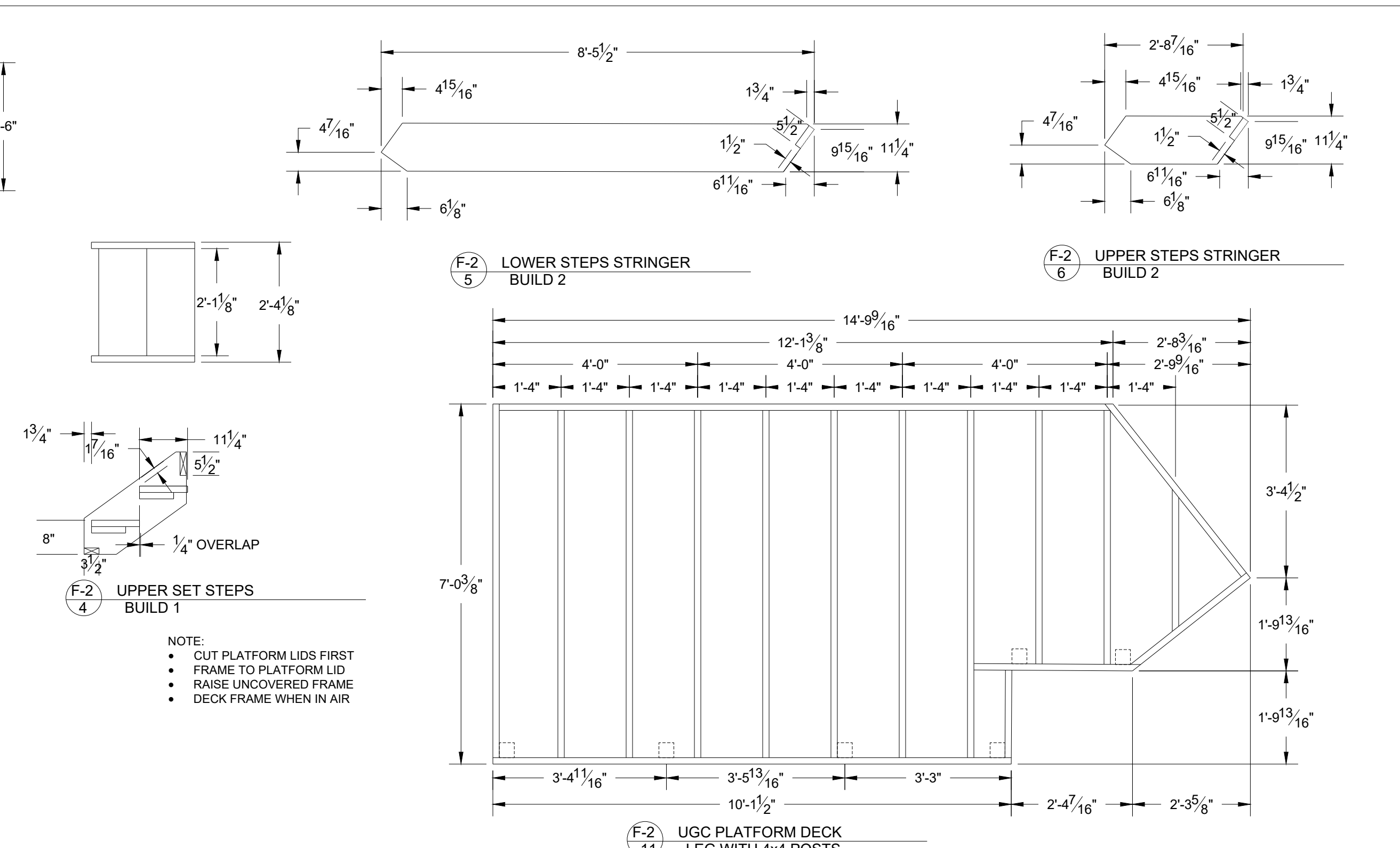
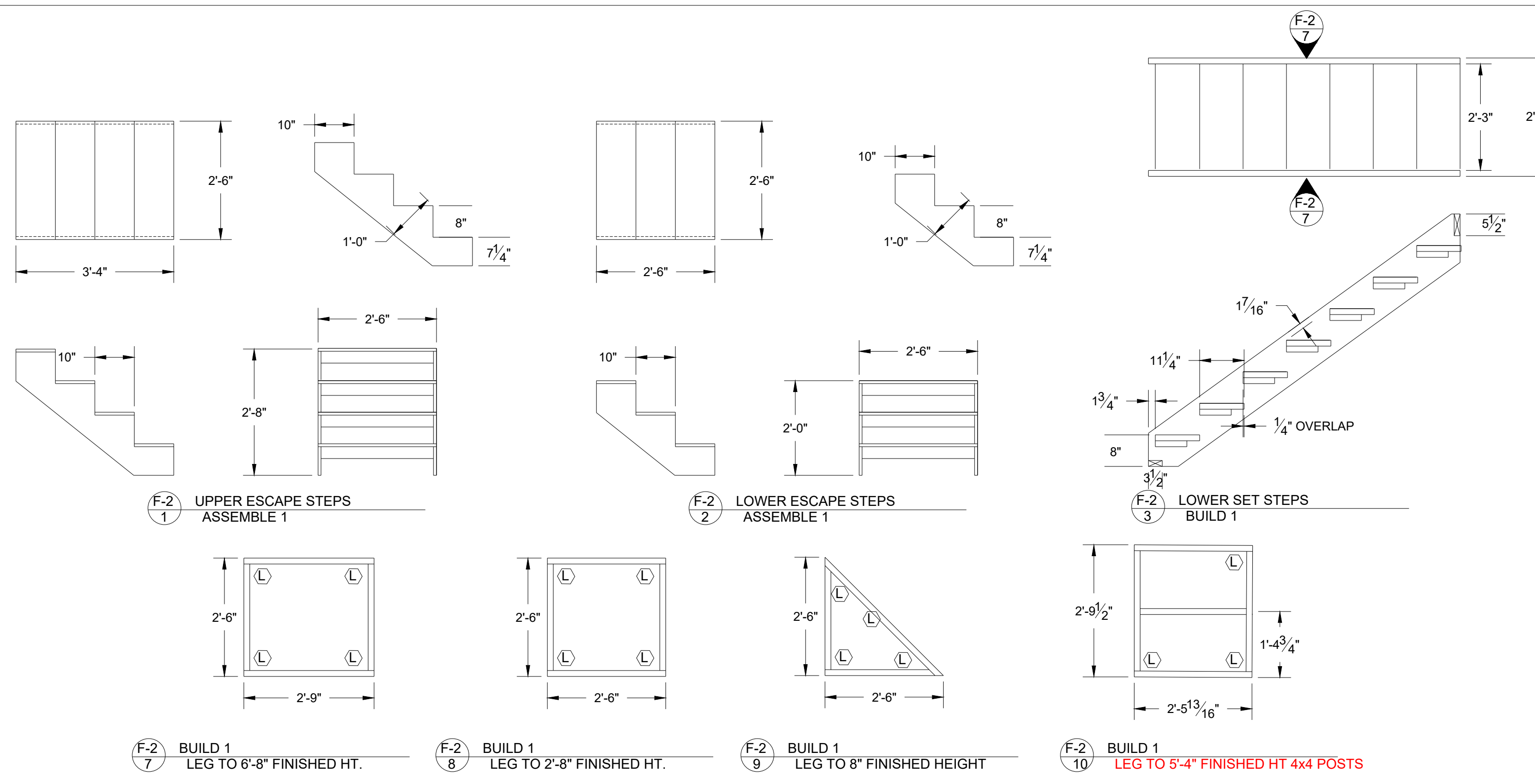

**NOTES**  
 COVER DOOR WAYS OF STUD WALLS WITH LAUAN THEN FACE AND ROUTE STUD WALLS

**NOTE:**  
 • CUT PLATFORM LIDS FIRST  
 • FRAME TO PLATFORM LID  
 • RAISE UNCOVERED FRAME  
 • DECK FRAME WHEN IN AIR

These drawings are instruments of service and as such remain the property of the creator. No copies or reproductions are permitted without the consent of the creator. Copyright (C) 2019

**FLORIDA ATLANTIC UNIVERSITY**  
 777 GLADES ROAD  
 BOCA RATON, FL 33431  
 PHONE: (561)297-3810 TD: (561)715-9898  
 FAX: (561)297-0611

MARK	DATE	REVISIONS/ISSUES
1		
2		
3		
4		
5		
6		
7		

**URINETOWN**  
 THEATRE: STUDIO ONE THEATRE @ FAU  
 DESIGNER: C. GRIFFEY  
 DIRECTOR: J. BALDET  
 ISSUE DATE: 10/5/19  
 AT FALL 2019

PLATE NUMBER  
**F-2**

SCALE:  
**1/2" = 1'-0"**

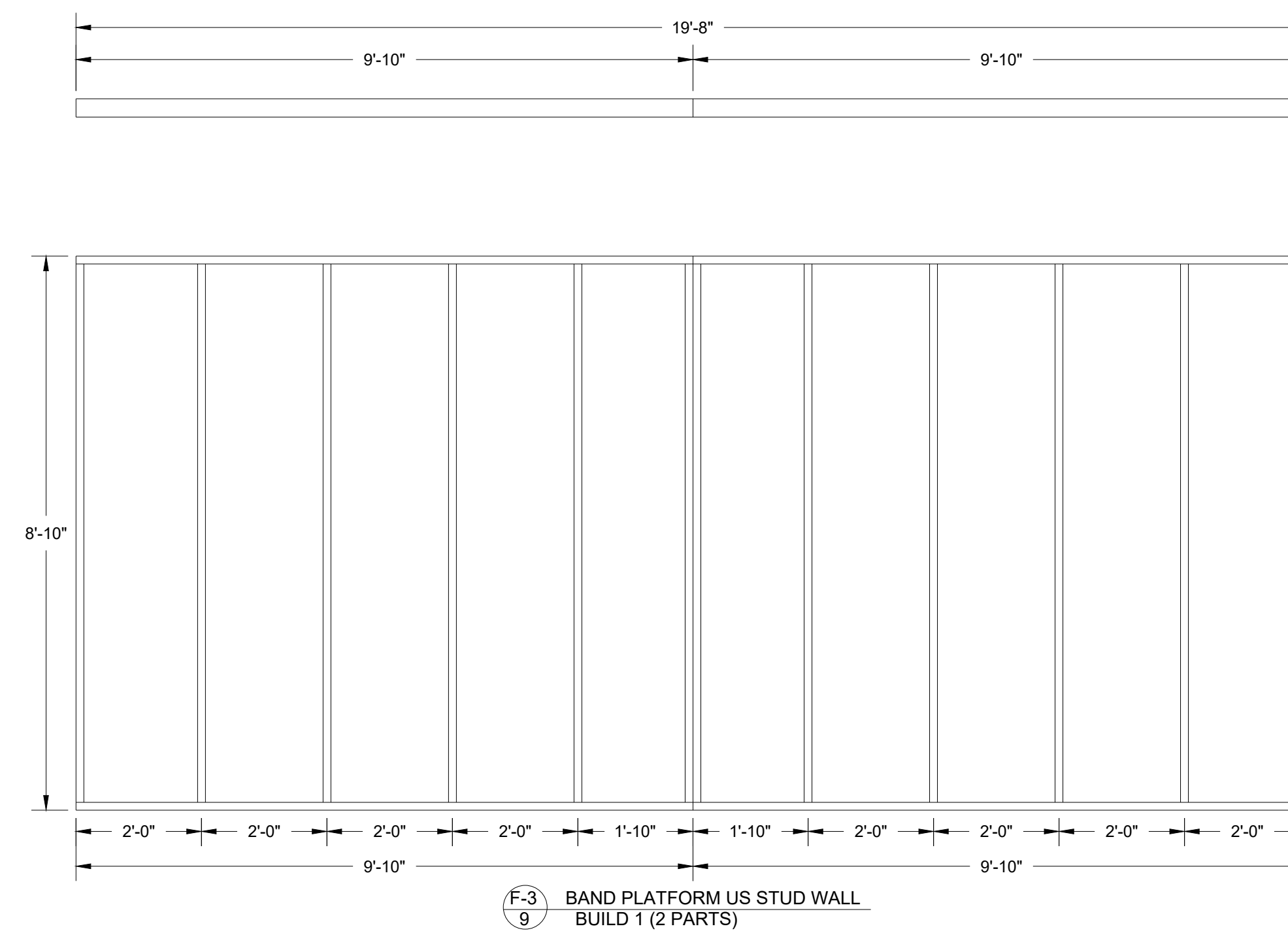
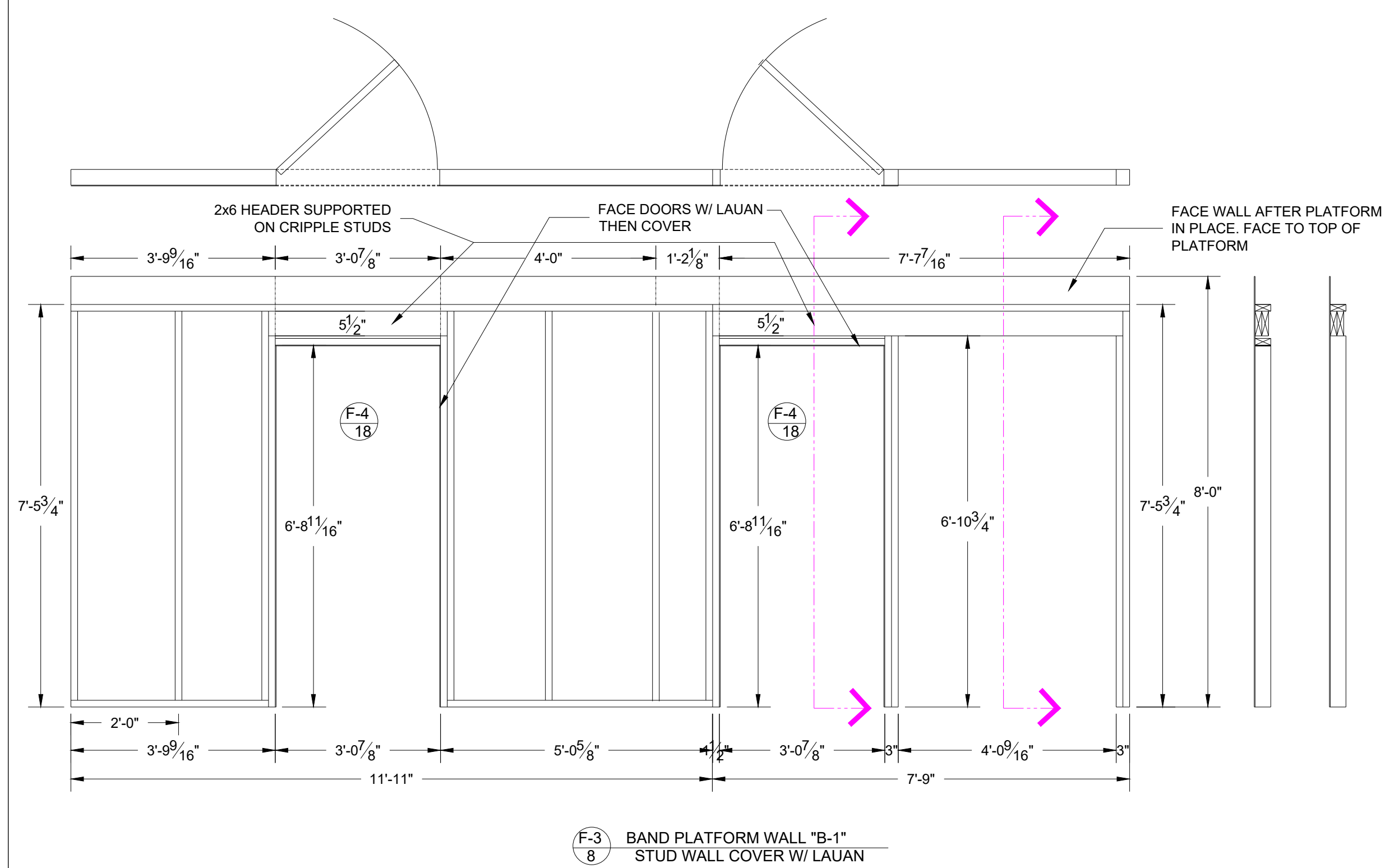
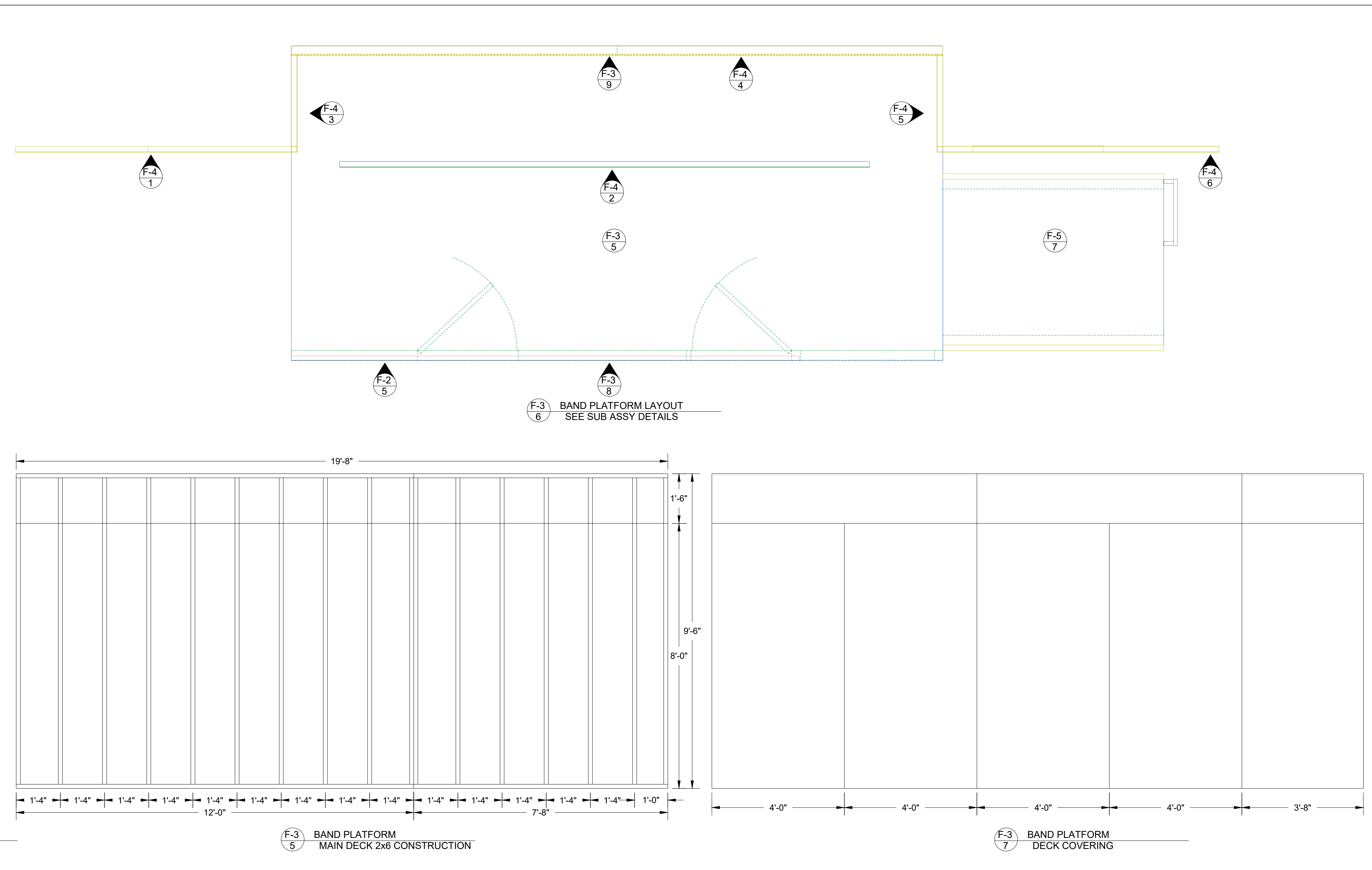
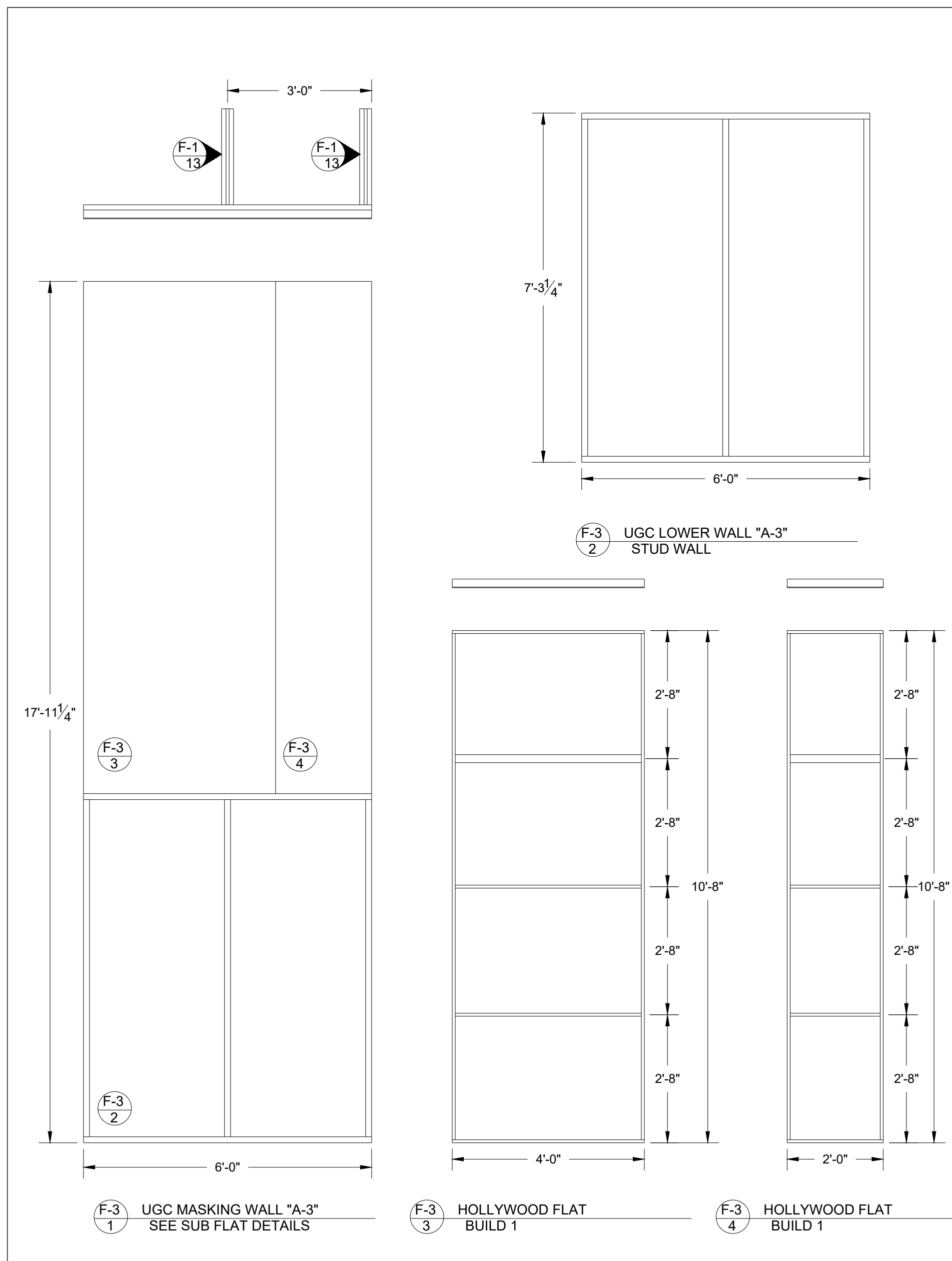

- NOTE:
- UPSTAGE WALL IS TAPCONED TO THE FLOOR AS NEEDED
  - DIAT BRACE AS NEEDED
  - SECURE DECK TO BUILDING STRUCTURE

These drawings are instruments of service and as such remain the property of the creator. No copies or reproductions are permitted without the consent of the creator. Copyright (C) 2019

**FLORIDA ATLANTIC UNIVERSITY**

777 GLADES ROAD  
BOCA RATON, FL 33431  
PHONE: (561)297-3810 TD: (561)715-9898  
FAX: (561)297-0611

MARK	DATE	REVISIONS/ISSUES
1		
2		
3		
4		
5		
6		
7		

**URINETOWN**

THEATRE: STUDIO ONE THEATRE @ FAU  
DESIGNER: C. GRIFFEY  
DIRECTOR: J. BALDET  
ISSUE DATE: 10/5/19  
AY FALL 2019

PLATE NUMBER  
**F-3**

SCALE:  
**1/2" = 1'-0"**



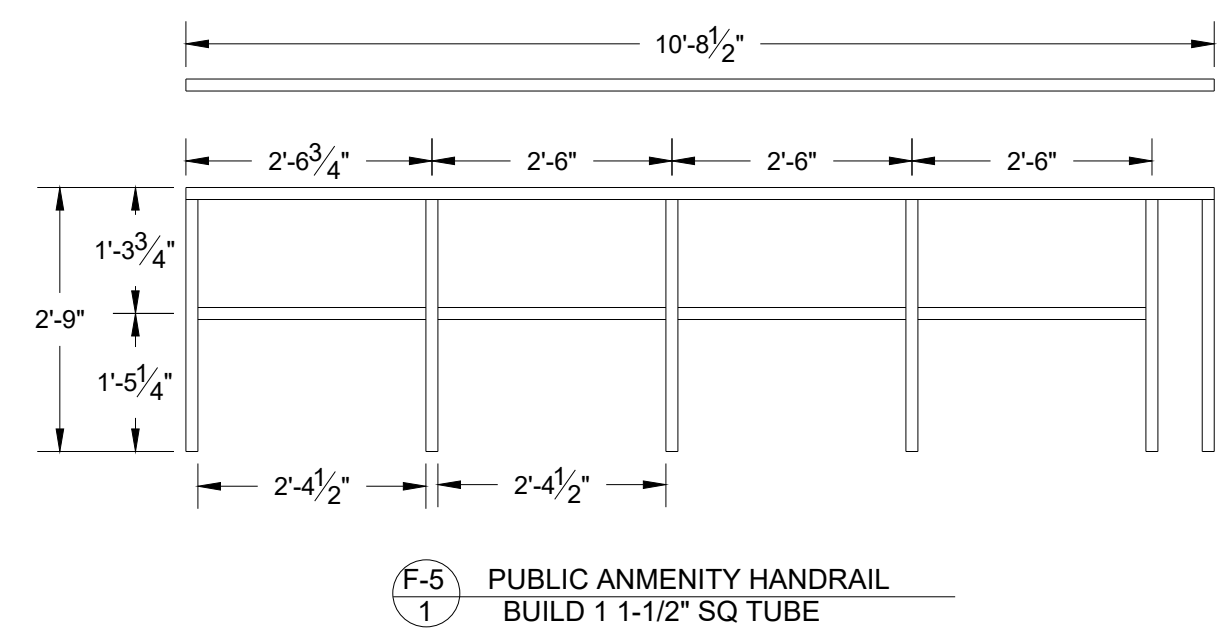

F-5 1 PUBLIC AMENITY HANDRAIL  
BUILD 1 1-1/2\"/>

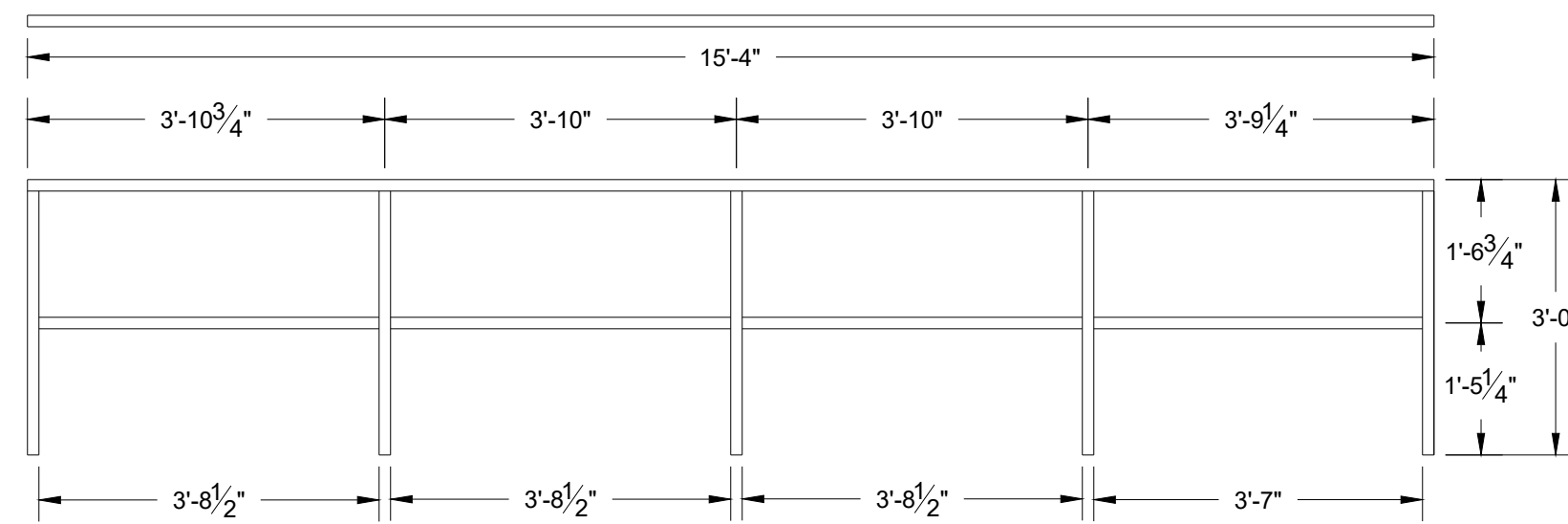

F-5 2 BAND PLATFORM HANDRAIL  
BUILD 1 1-1/2\"/>

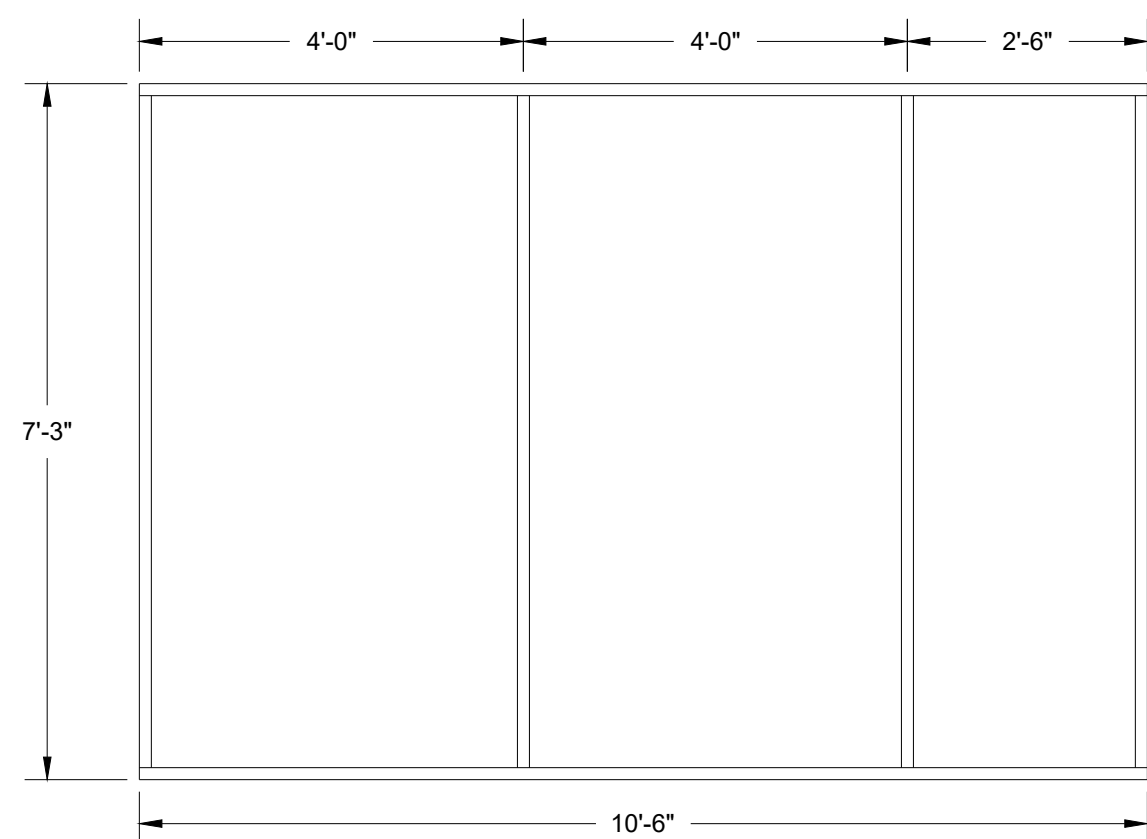

F-5 3 CRASH PAD PLATFORM  
BUILD 1 2x6 FRAME

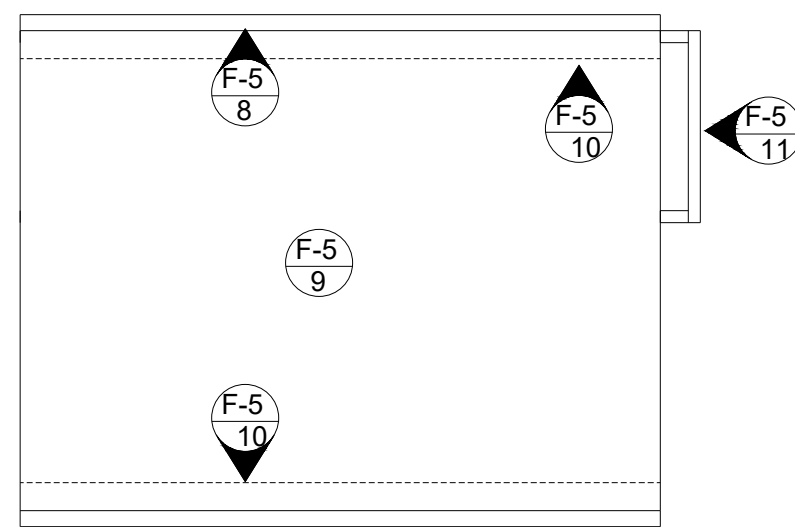

F-5 7 CRASH PAD PLATFORM  
BUILD 1

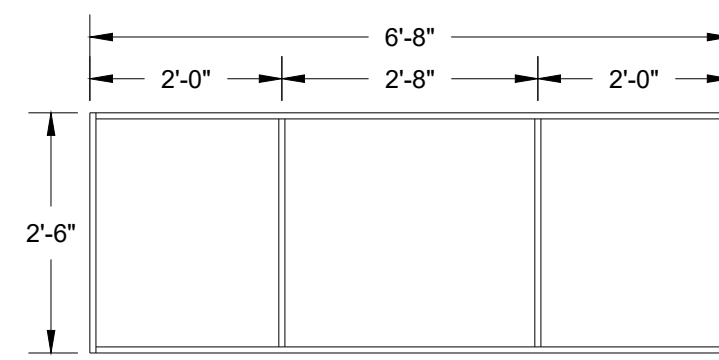

F-5 8 CRASH PLATFORM SAFETY FLATS  
BUILD 2 HOLLYWOOD

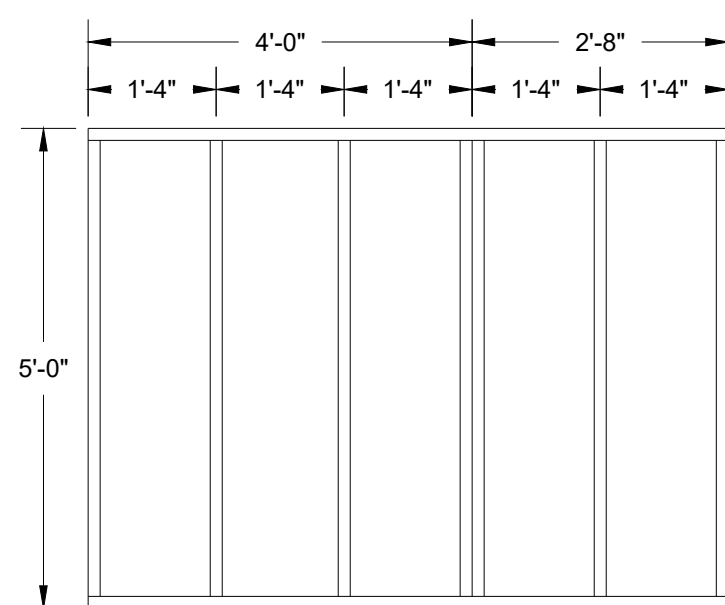

F-5 9 CRASH PAD PLATFORM  
BUILD 1 2x6 FRAME

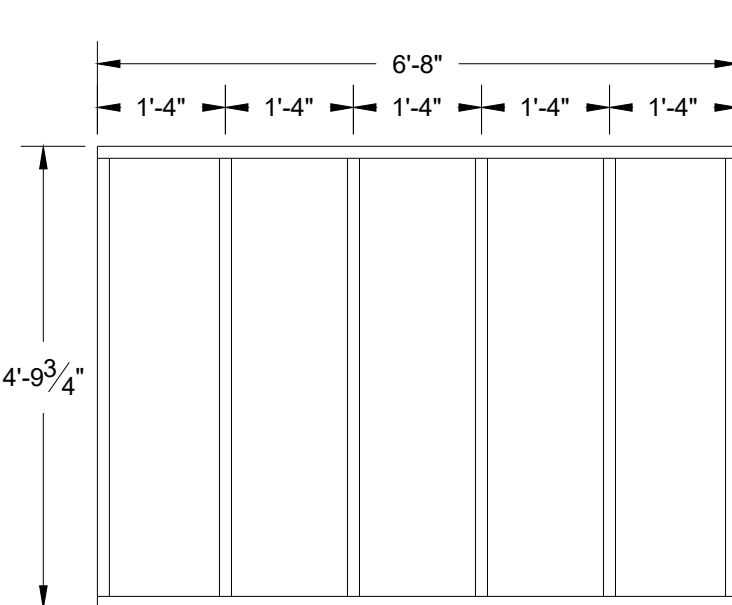

F-5 10 CRASH PAD STUD WALL  
BUILD 2 2x4 WALL CONSTRUCTION

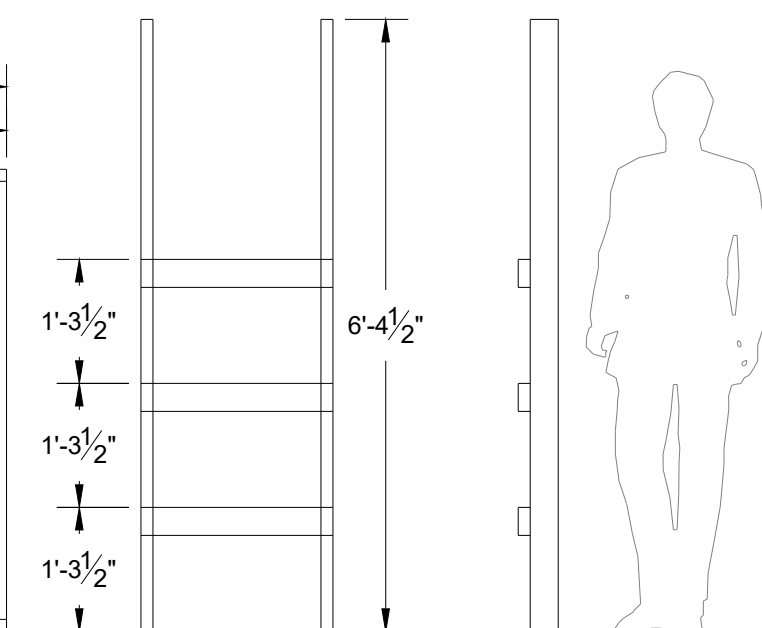

F-5 11 ESCAPE STEP UNIT  
BUILD 1 2x4 CONSTRUCTION

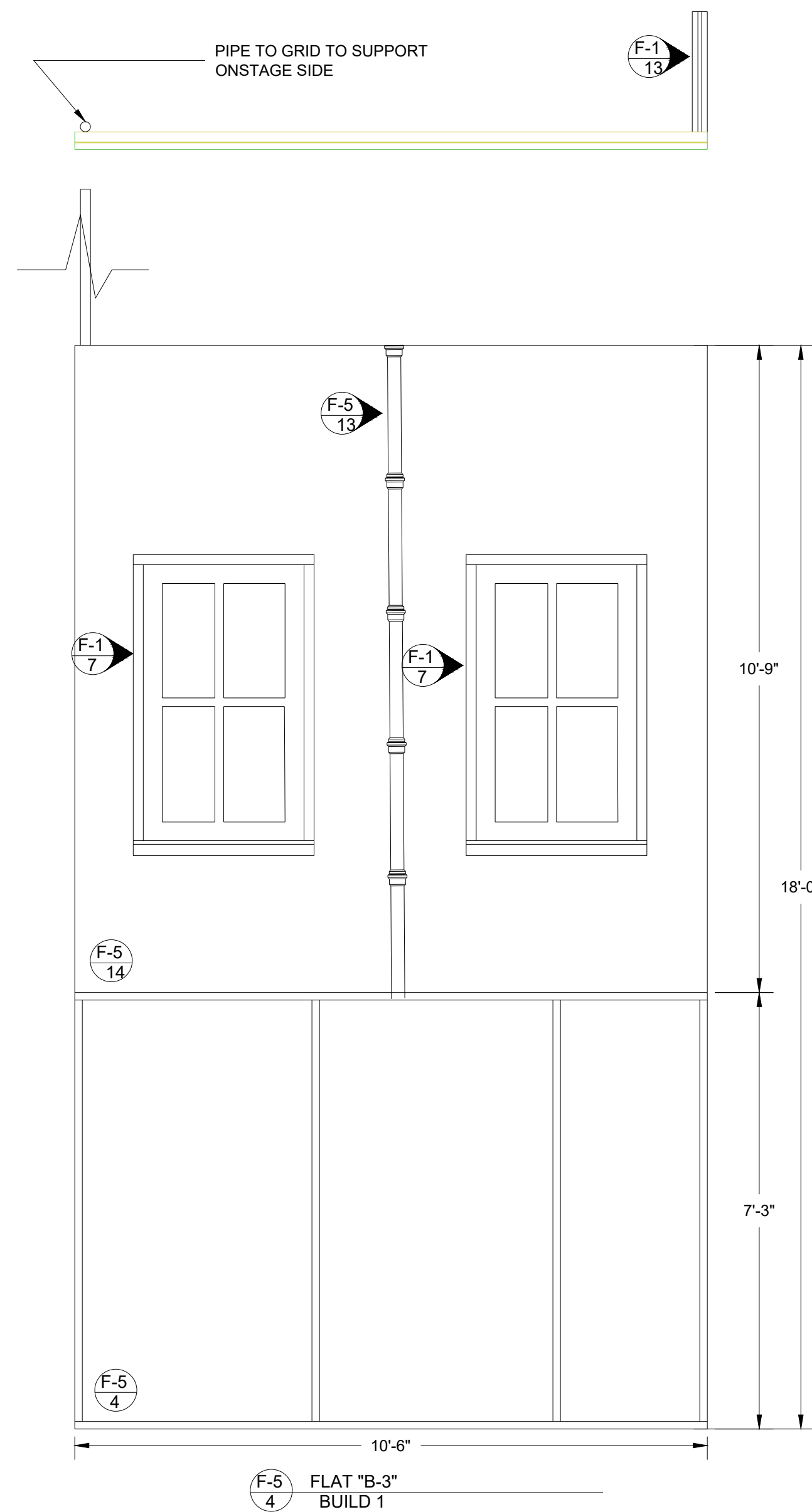

F-5 4 FLAT "B-3"  
BUILD 1

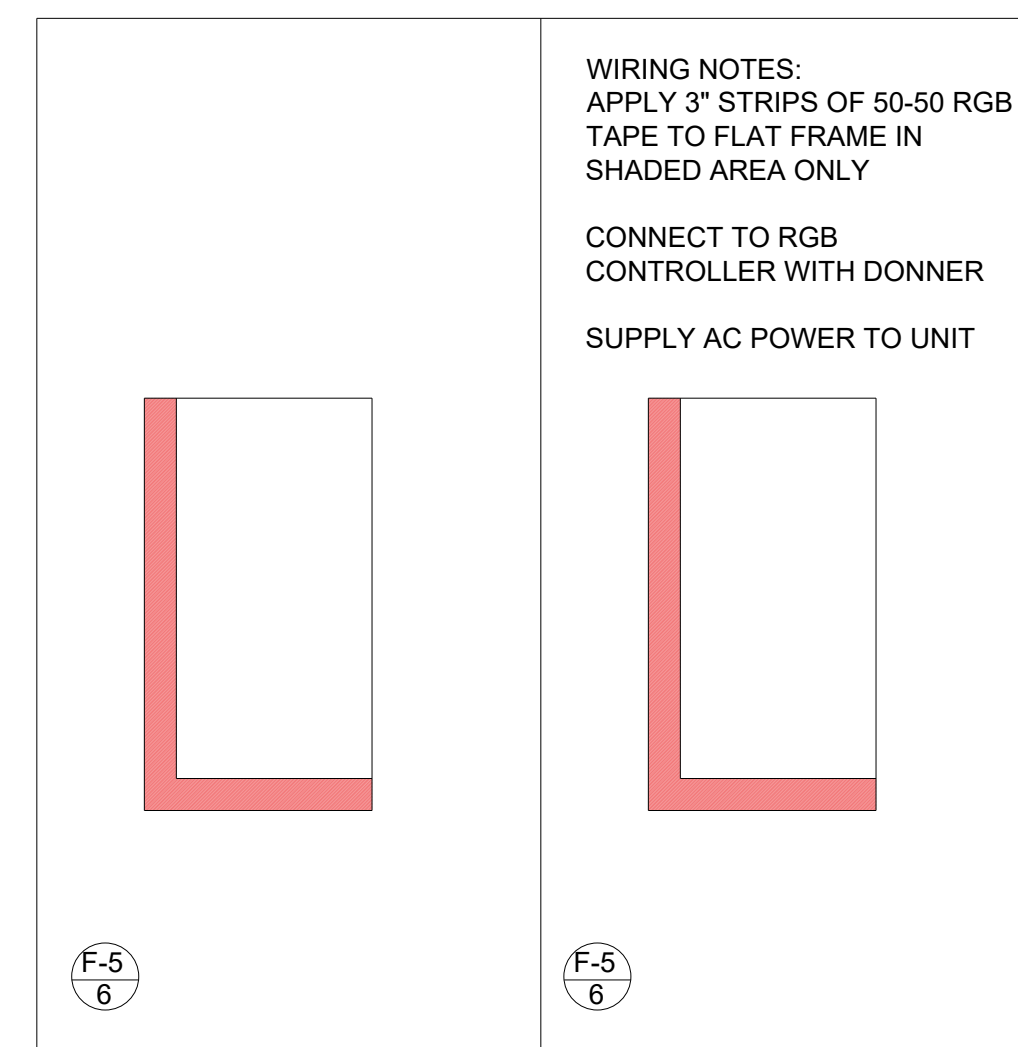

WIRING NOTES:  
APPLY 3\"/>

F-5 5 FLAT "B-3" LAYOUT  
NOTE LIGHT BOX HOLDBACKS

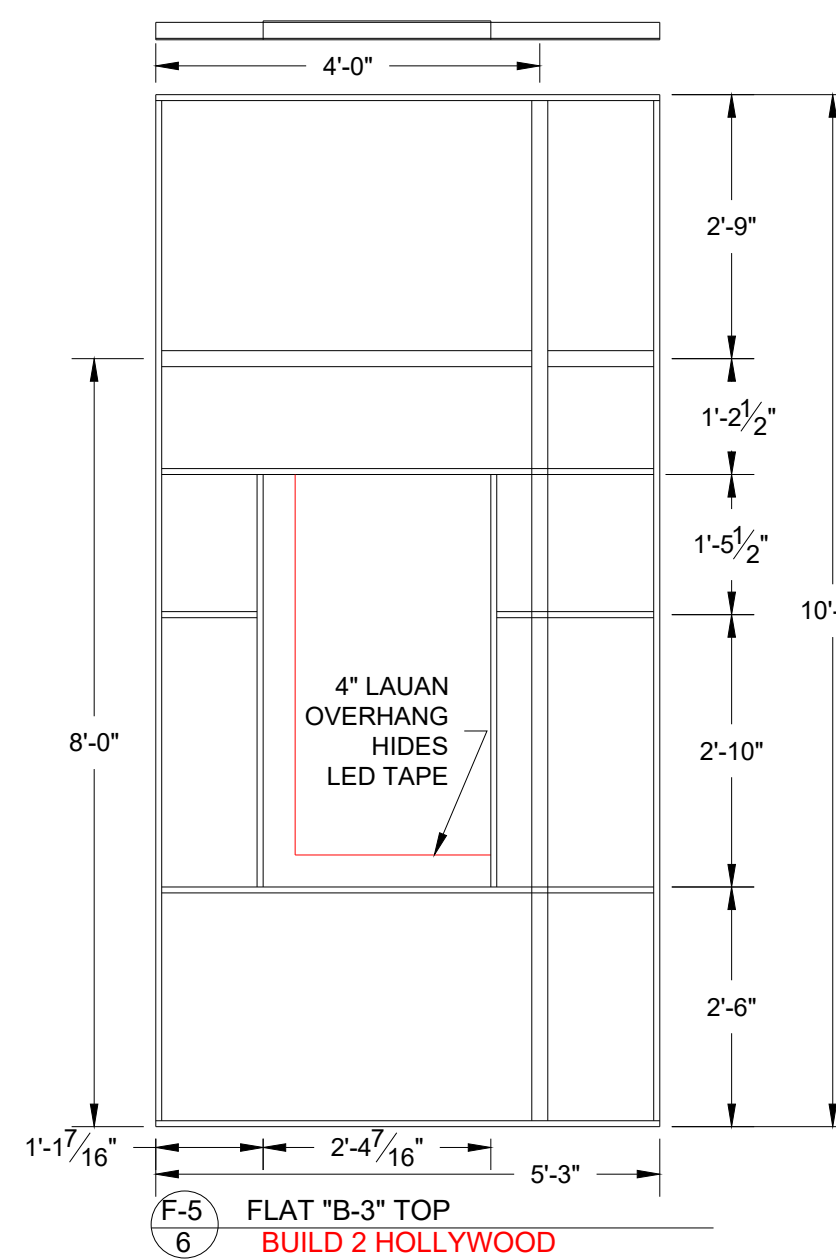

F-5 6 FLAT "B-3" TOP  
BUILD 2 HOLLYWOOD

NOTE:  
COVER BACK OF OPENING  
WITH LAUAN TO FRAME

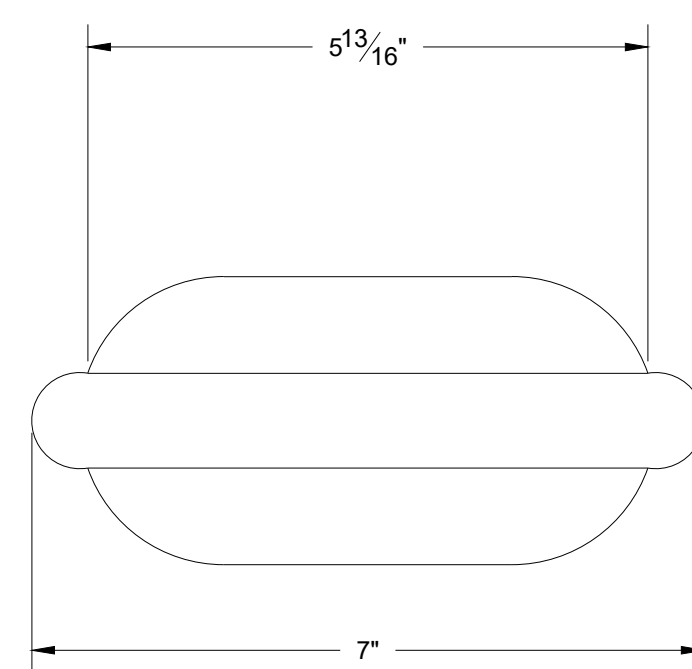

F-5 12 PIPE JOINT DETAIL  
BUILD 20

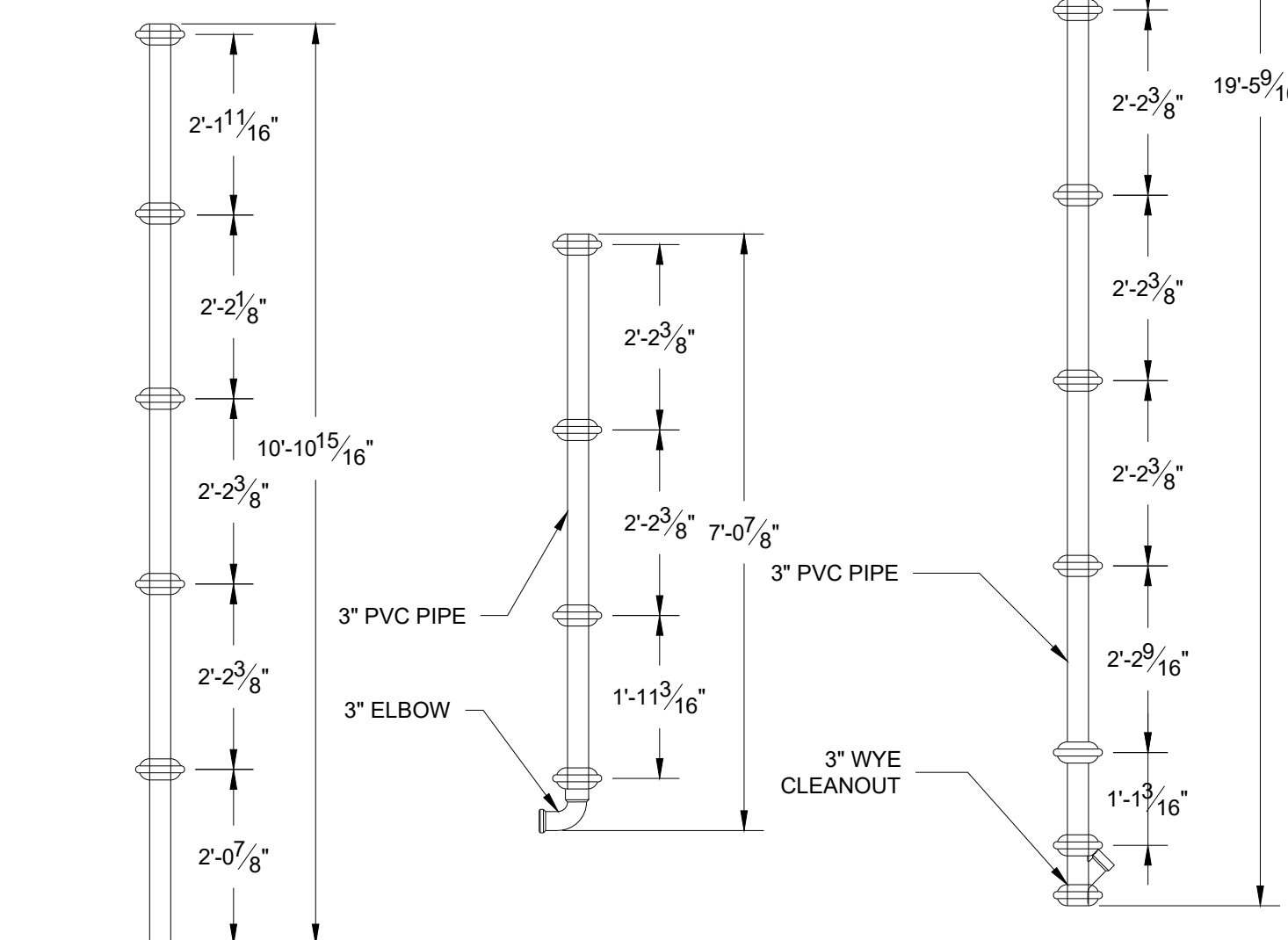
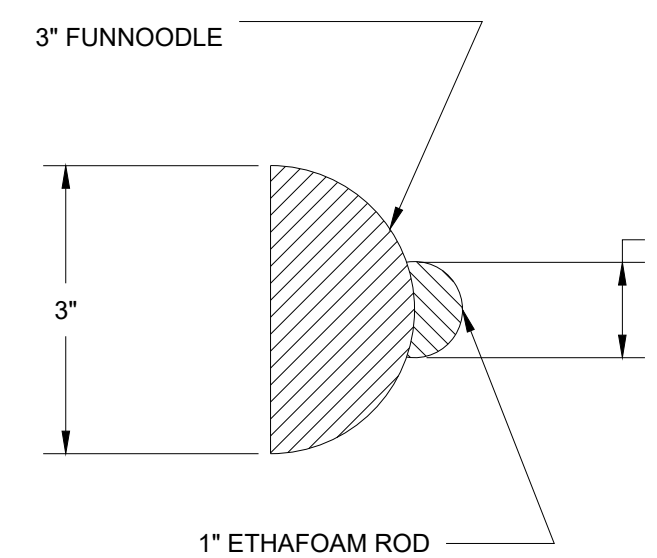

F-5 13 PIPE "B-3" DETAIL  
BUILD 1

F-5 14 PIPE "C-1" DETAIL  
BUILD 1

F-5 15 PIPE "A-1" DETAIL  
BUILD 1

NOTES:  
BUILD FOAM WRAPS IN PLACE  
ATTACH TO FLATS  
HOT GLUE ATTACH  
OPEN TO DISCUSS OTHER OPTIONS

These drawings are instruments of service and as such remain the property of the creator. No copies or reproductions are permitted without the consent of the creator. Copyright (C) 2019

FLORIDA ATLANTIC UNIVERSITY

777 GLADES ROAD  
BOCA RATON, FL 33431  
PHONE: (561)297-3810 TD: (561)715-9898  
FAX: (561)297-0611

REVISIONS/ISSUES

MARK	DATE	REVISIONS/ISSUES
1		
2		
3		
4		
5		
6		
7		

URINETOWN

THEATRE: STUDIO ONE THEATRE @ FAU  
DESIGNER: C. GRIFFEY  
DIRECTOR: J. BALDET  
ISSUE DATE: 10/5/19  
AY FALL 2019

PLATE NUMBER  
**F-5**

SCALE:  
**1/2" = 1'-0"**

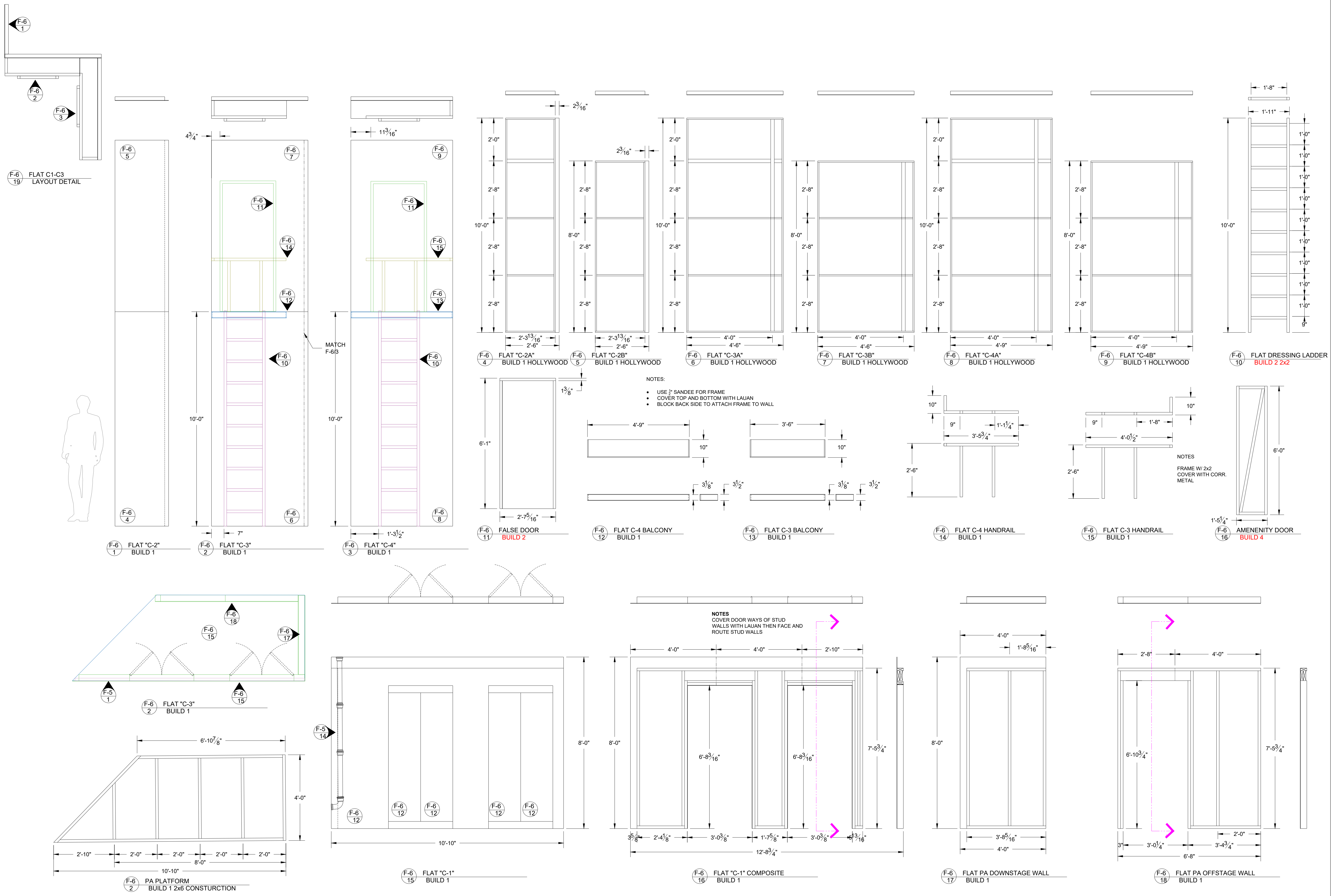

These drawings are instruments of service and as such remain the property of the creator. No copies or reproductions are permitted without the consent of the creator. Copyright (C) 2019

**FLORIDA ATLANTIC UNIVERSITY**

777 GLADES ROAD  
 BOCA RATON, FL 33431  
 PHONE: (561)297-3810 TD: (561)715-9898  
 FAX: (561)297-0611

MARK	DATE	REVISIONS/ISSUES
1		
2		
3		
4		
5		
6		
7		

**URINETOWN**

THEATRE: STUDIO ONE THEATRE @ FAU  
 DESIGNER: C. GRIFFEY  
 DIRECTOR: J. BALDET  
 ISSUE DATE: 10/6/19  
 AY FALL 2019

SCALE: **1/2" = 1'-0"**

PLATE NUMBER **F-6**

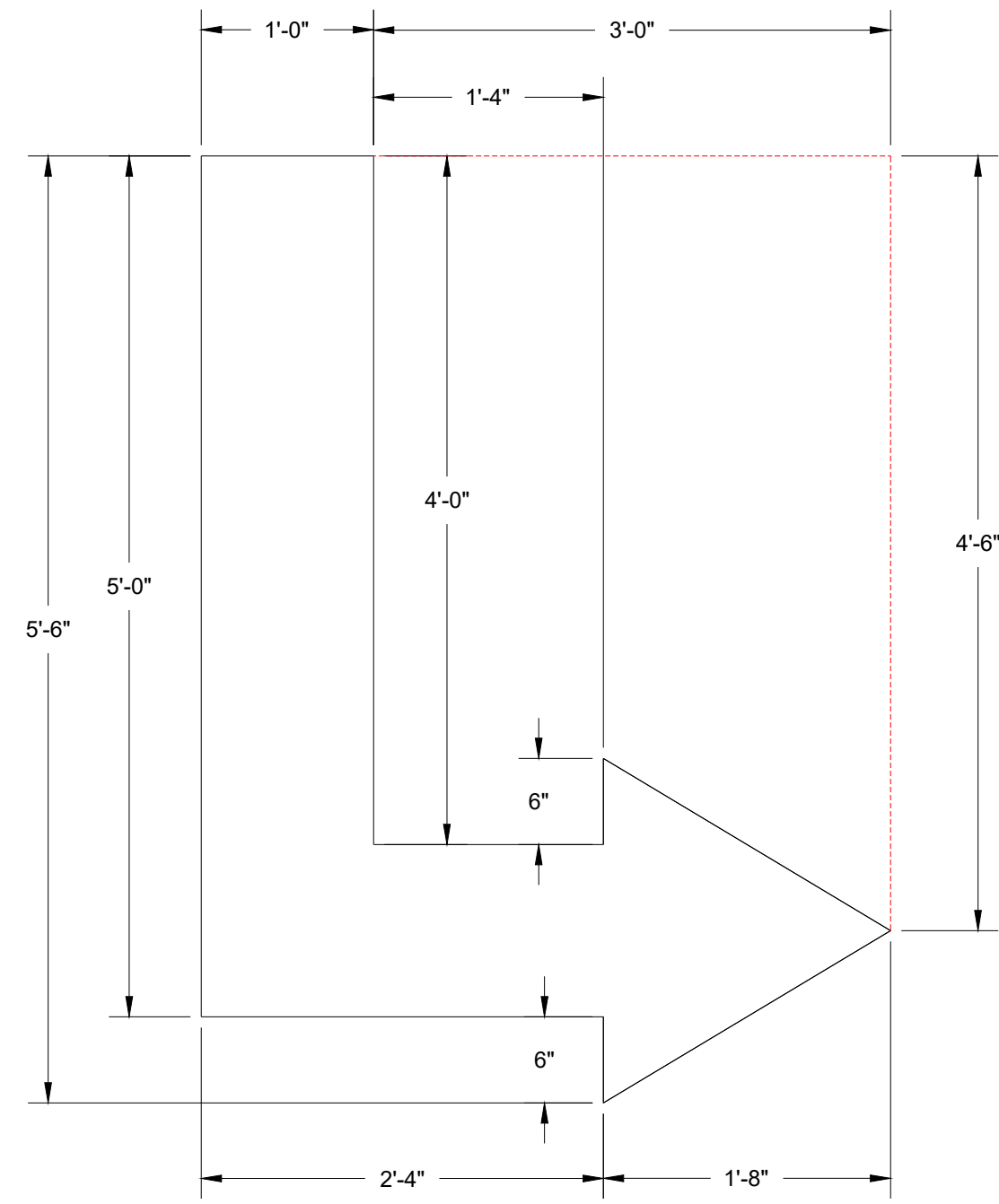

(F-7)  
1 HIDEOUT ARROW  
CUT 1 1/2" PLY LINE WITH LED

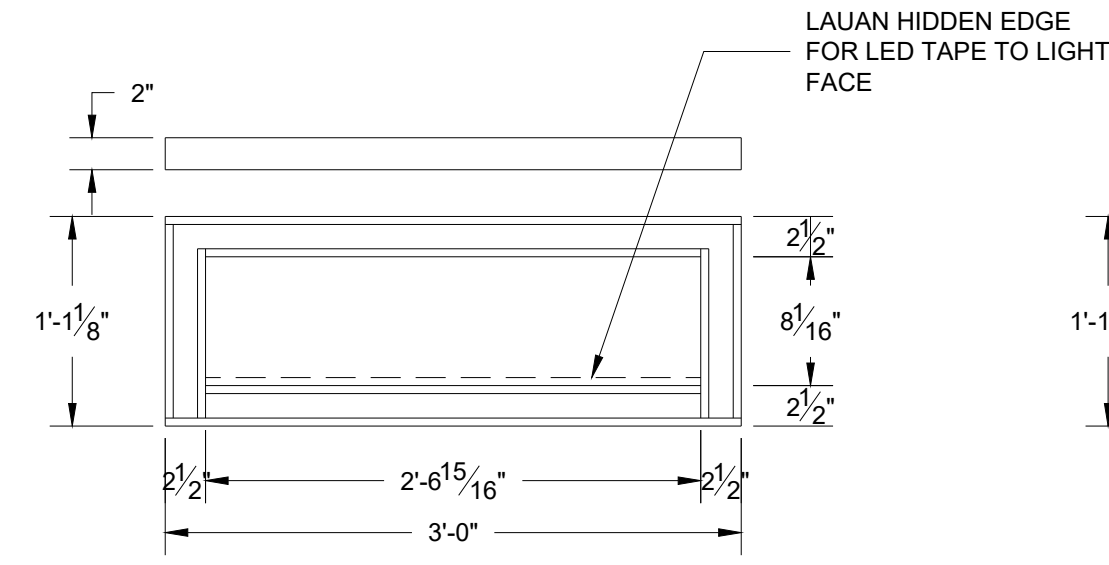

(F-7)  
2 HIDEOUT SIGN CARCASS  
BUILD 2 1/2" SANDEE

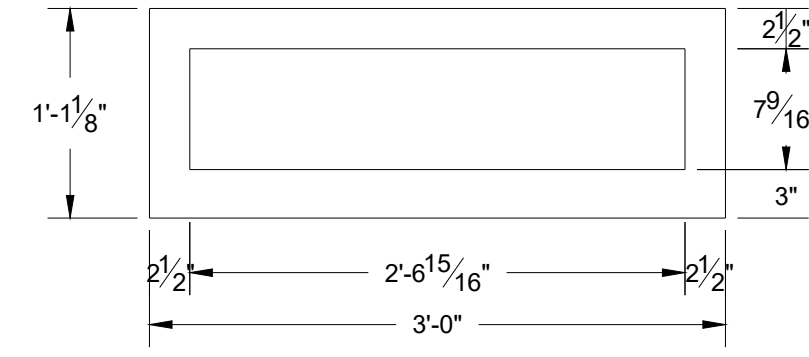

(F-7)  
3 HIDEOUT SIGN FRONT  
CUT 2 3/16" LAUAN

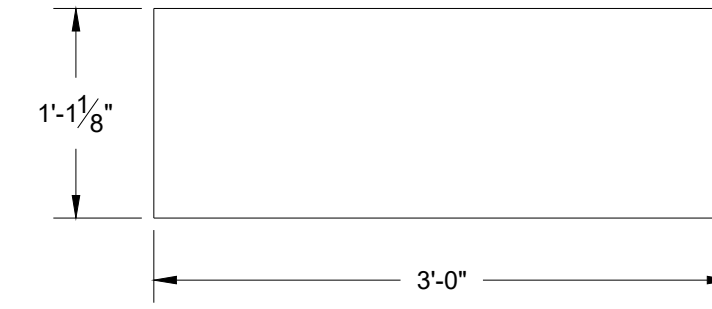

(F-7)  
4 HIDEOUT SIGN BACKING  
CUT 2 3/16" LAUAN

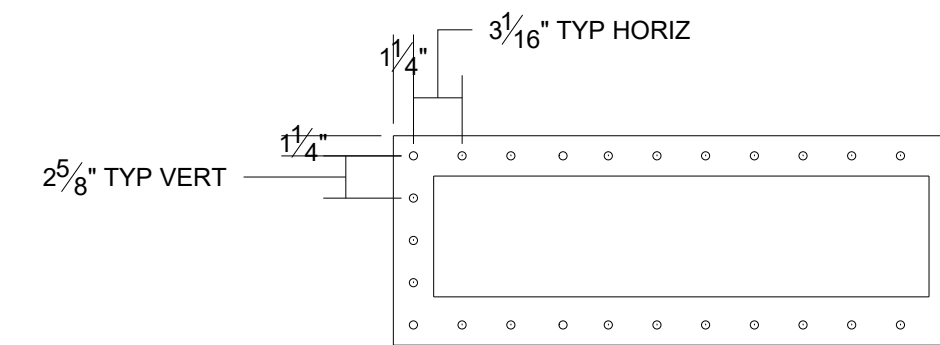

(F-7)  
5 HIDEOUT SIGN DRILL PATTERN  
DRILL 2 FROM F-7/3

NOTE:  
1/2" HOLE FOR PING PONG  
LIGHTS

These drawings are instruments of service and as such remain the property of the creator. No copies or reproductions are permitted without the consent of the creator. Copyright (C) 2019

**FLORIDA ATLANTIC UNIVERSITY**

777 GLADES ROAD  
BOCA RATON, FL 33431  
PHONE: (561)297-3810, TD: (561)715-9898  
FAX: (561)297-0611

MARK	DATE	REVISIONS/ISSUES
1		
2		
3		
4		
5		
6		
7		

**URINETOWN**

THEATRE: STUDIO ONE THEATRE @ FAU  
DESIGNER: C GRIFFEY  
DIRECTOR: J. BALDET  
ISSUE DATE: 10/5/19  
AY FALL 2019

PLATE NUMBER  
**F-7**

SCALE:  
**1" = 1'-0"**



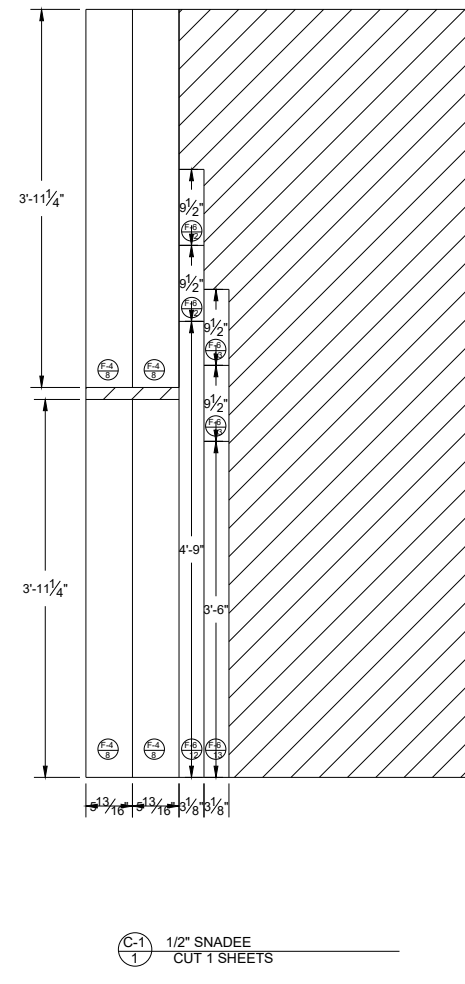
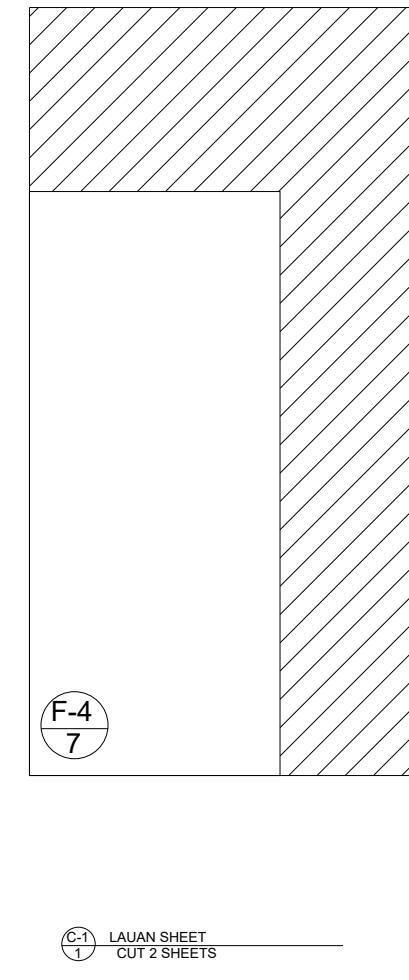
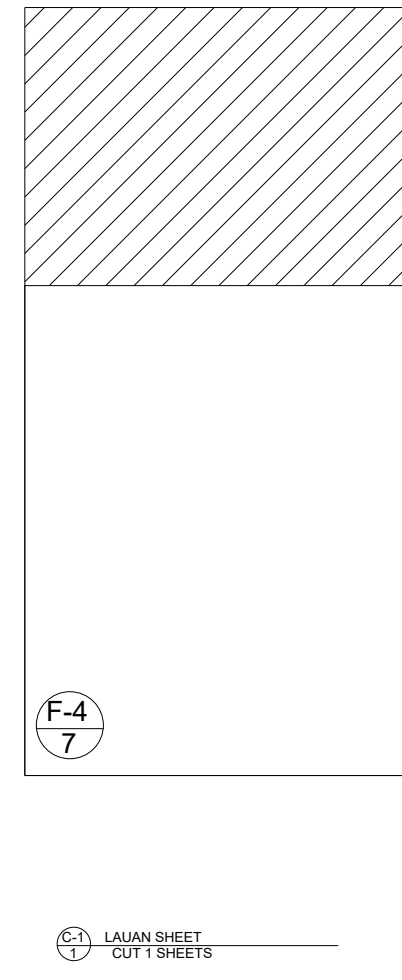
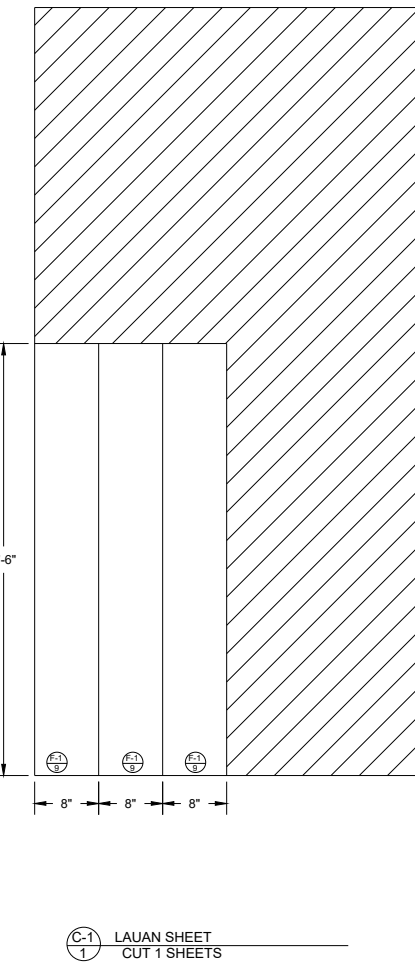
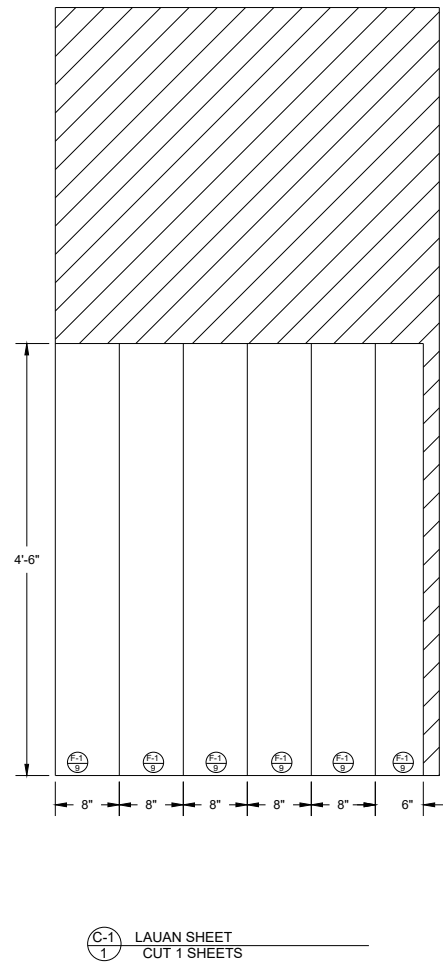
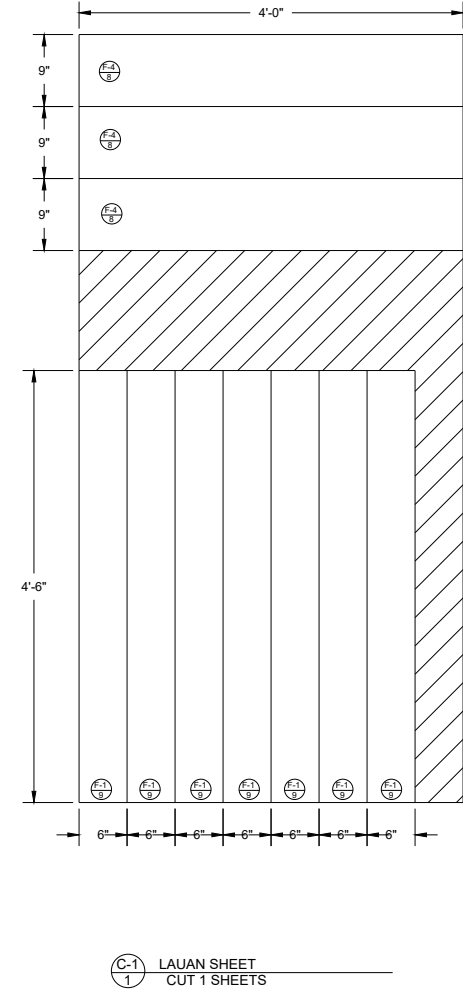
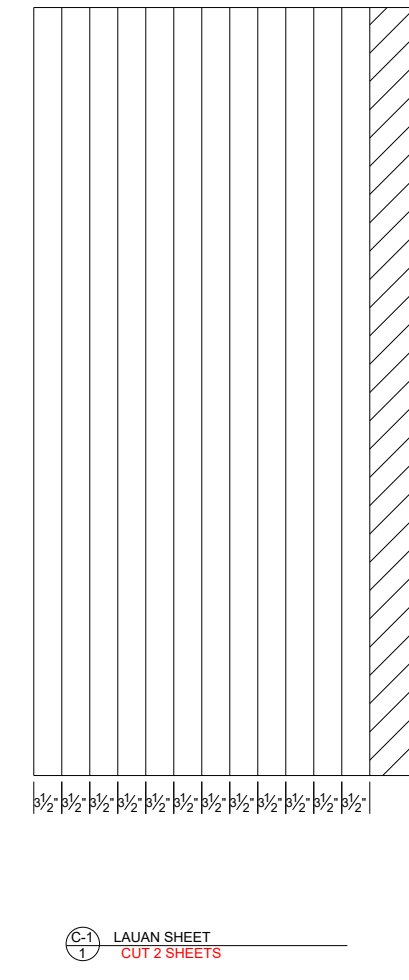
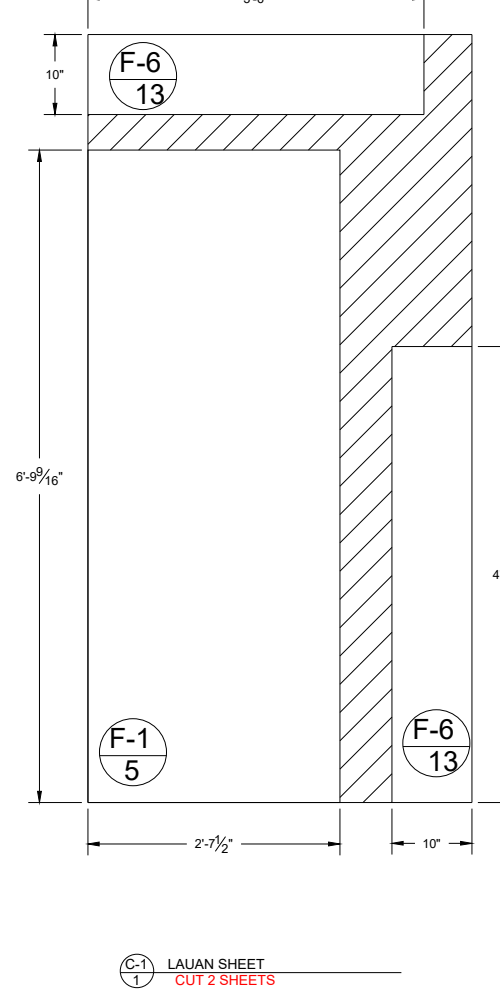
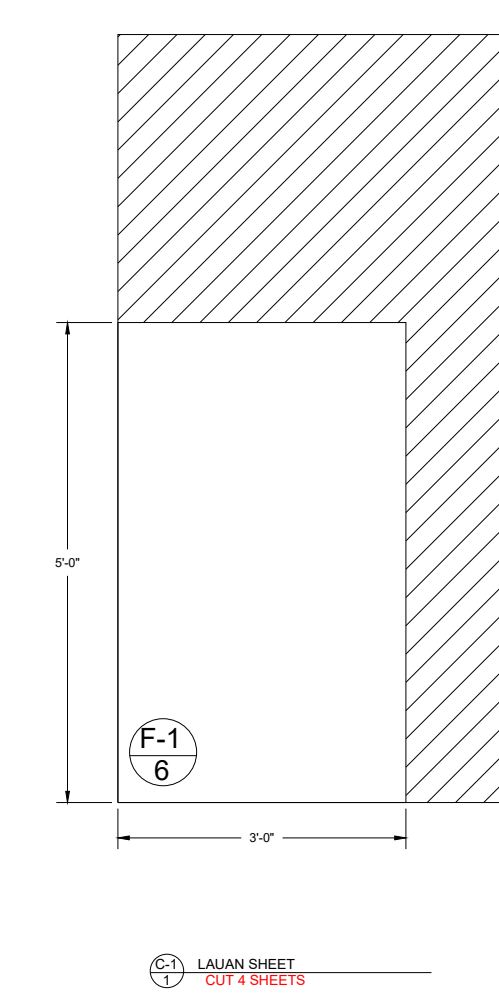
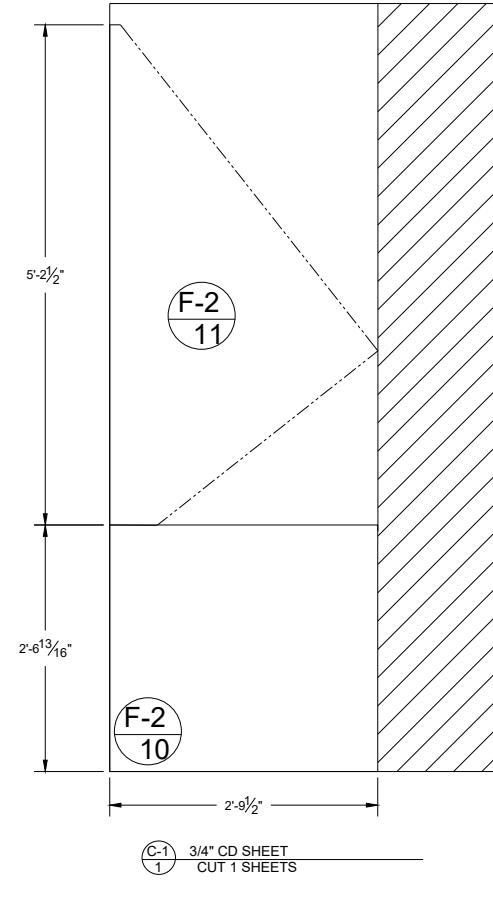
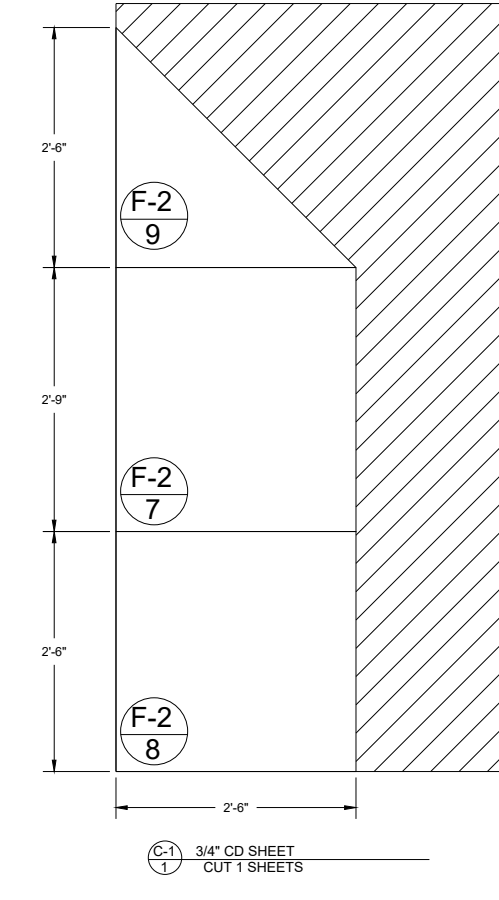

These drawings are instruments of service and as such remain the property of the creator. No copies or reproductions are permitted without the consent of the creator. Copyright (C) 2019

**FLORIDA ATLANTIC UNIVERSITY**  
 777 GLADES ROAD  
 BOCA RATON, FL 33431  
 PHONE: (561)297-3810, TD: (561)715-9898  
 FAX: (561)297-0611

MARK	DATE	REVISIONS/ISSUES
1		
2		
3		
4		
5		
6		
7		

**URINETOWN**  
 THEATRE: STUDIO ONE THEATRE @ FAU  
 DESIGNER: C GRIFFEY  
 DIRECTOR: J. BALDET  
 ISSUE DATE: 10/5/19  
 AY FALL 2019

PLATE NUMBER  
**C-1**

SCALE:  
**1/2" = 1'-0"**